

FOSTER ROAD

OCASO AVENUE

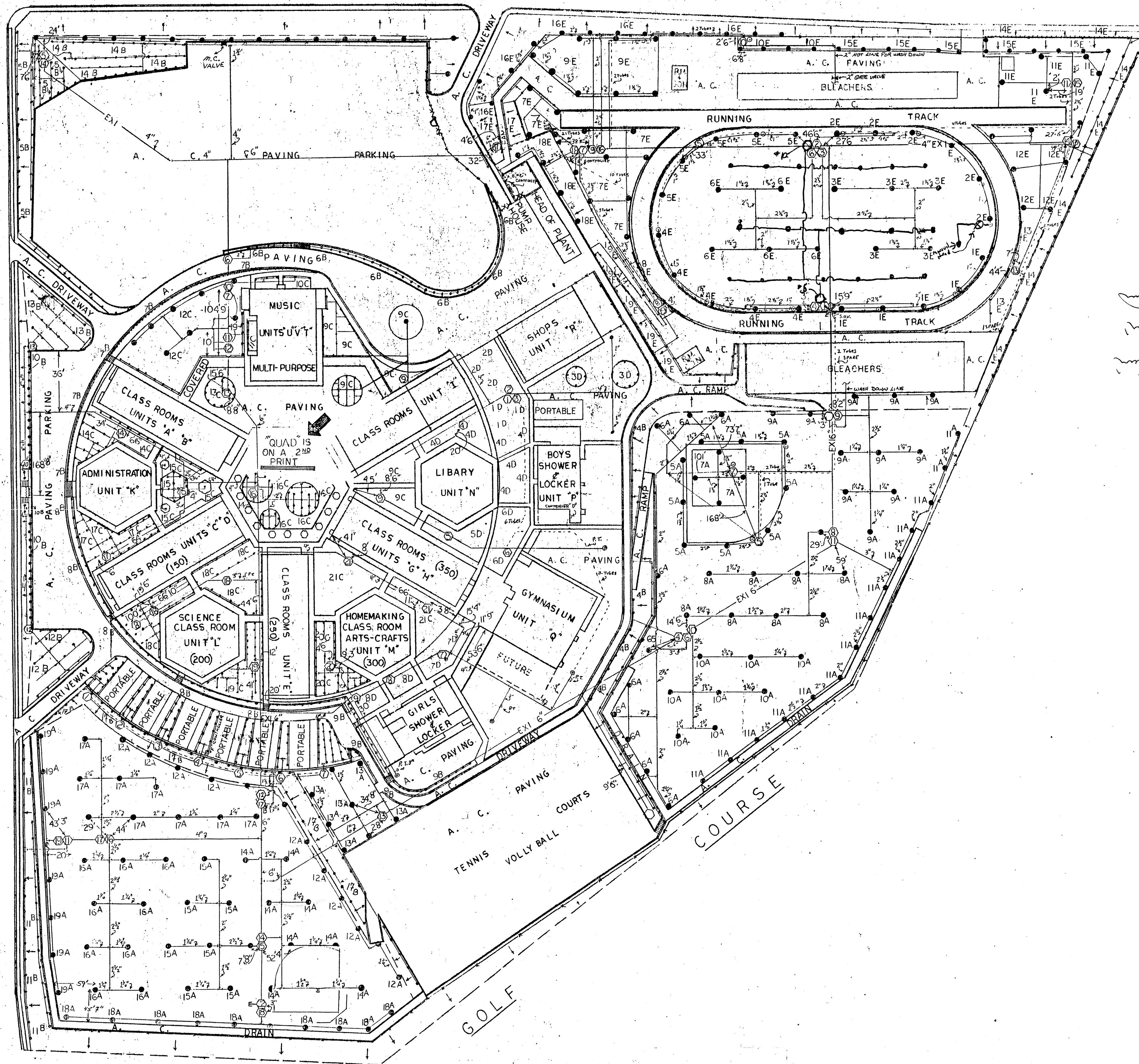

1-Tuffler on class station  
 182-Tuffler on class station  
 2-Tuffler on class station

VALVE 17B IS 13'4" SOUTH OF 6" GATE VALVE  
 SPARE VALVE #23A IS LOCATED @ VALVE 9A

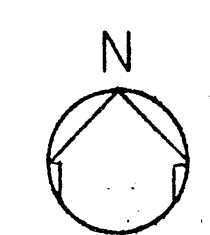

**FOR REFERENCE ONLY**

<b>LAMIRADA HIGH SCHOOL</b>			
SCALE: 1" = 80'0"	APPROVED BY:	DATE:	DRAWN BY:
DATE: 12-87			REVIEWED BY:
NORWALK LA MIRADA UNIFIED SCHOOL DISTRICT		NORWALK, CALIFORNIA	
EXTERIOR ONLY		DRAWING NUMBER:	