

MECH CLOSET COMB. AIR & FLUE PLAN

SCALE : 1/4" = 1'-0'

DRAWING NOTES :

- 1 COVER WINDOW LOUVER W/15" DEEP INSULATED SHEET METAL SANDWICH PANEL.
- 2 12" ID INSULATED COMBUSTION AIR DUCT.
- 3 8" ID INSULATED COMBUSTION AIR DUCT DN TO WATER HEATER.
- 4 8" ID DOUBLE WALL INSULATED FLUE FROM WATER HEATER.
- 5 12" ID DOUBLE WALL INSULATED FLUE THRU ROOF.

1 THIRD FLOOR PLAN – PLUMBING WORK

SCALE : 1/8" = 1'-0"

NOTES :

- 1- REFER TO DRAWING MPE-1 FOR HVAC, PLUMBING/FIRE PROTECTION & ELECTRICAL
GENERAL NOTES, ABBREVIATIONS, LEGENDS & DRAWING LIST.

DRAWING NOTES :

- | | | | | | |
|----|--|----|---|----|---|
| 1 | 1" LP GAS DN TO FIRE PLACE | 11 | 2" UP TO RD (478 SQ FT) REFER TO PLAN 1P-5 FOR LOCATION | 20 | 3" RL UP (978 SQ FT) REFER TO PLAN 1P-5 FOR CONTINUATION. 3" RL DN (1,673 SQ FT) REFER TO PLAN 1P-3 FOR CONTINUATION. |
| 2 | 2-1/2" C-1-12 1/2" HW & 1-1/4" 2BG UP. REFER TO PLAN 1P-5 1 FOR CONTINUATION | 12 | 2" UP TO ROD (478 SQ FT) REFER TO PLAN 1P-5 FOR LOCATION | 21 | 3" ROD UP (978 SQ FT) REFER TO PLAN 1P-5 FOR CONTINUATION. 3" ROD DN (1,673 SQ FT) REFER TO PLAN 1P-3 FOR CONTINUATION. |
| 3 | 3/4" LP GAS UP TO PENTHOUSE FIRE PLACE | 13 | 2" RL DN (478 SQ FT) REFER TO PLAN 1P-3 FOR CONTINUATION | 22 | 1/2" 45 DEGREE HW UP TO DISHWASHER |
| 4 | 2" #2 GAS UP TO GENERATOR. REFER TO PLAN 1P-5 FOR CONTINUATION | 14 | 2" ROD DN (478 SQ FT) REFER TO PLAN 1P-3 FOR CONTINUATION | | |
| 5 | 3/4" #2 GAS UP TO RTU2. REFER TO PLAN 1P-5 FOR CONTINUATION | 15 | 3" RL DN (956 SQ FT) REFER TO PLAN 1P-3 FOR CONTINUATION | | |
| 6 | 3/4" #2 GAS UP TO RTU1. REFER TO PLAN 1P-5 FOR CONTINUATION | 16 | 3" ROD DN (956 SQ FT) REFER TO PLAN 1P-3 FOR CONTINUATION | | |
| 7 | 3/4" #2 GAS UP TO RTU3. REFER TO PLAN 1P-5 FOR CONTINUATION | 17 | 2" RL UP (956 SQ FT) REFER TO PLAN 1P-5 FOR CONTINUATION | | |
| 8 | 3" Ø INLET & EXHAUST FROM WATER HEATER TO CONCENTRIC VENT TERMINATION FITTING ABOVE & THEN THRU ROOF | 18 | 2" ROD DN (956 SQ FT) REFER TO PLAN 1P-5 FOR CONTINUATION | | |
| 9 | EXTEND RELIEF VALVE DISCHARGE (FULL SIZE) TO FLOOR DRAIN. | 19 | INSTALL INSULATED GALVANIZED DRIP PAN BELOW RL PIPING WITHIN ELECTRICAL ROOM. EXTEND 1-1/4" INSULATED DRAIN FROM PAN AND CONNECT TO RP CONDENSATE DRAIN PIPING IN VICINITY. | | |
| 10 | FOR CONTINUATION OF PIPING REFER TO PENTHOUSE PLAN SAN. PIPING WORK (P-5.1) | | | | |

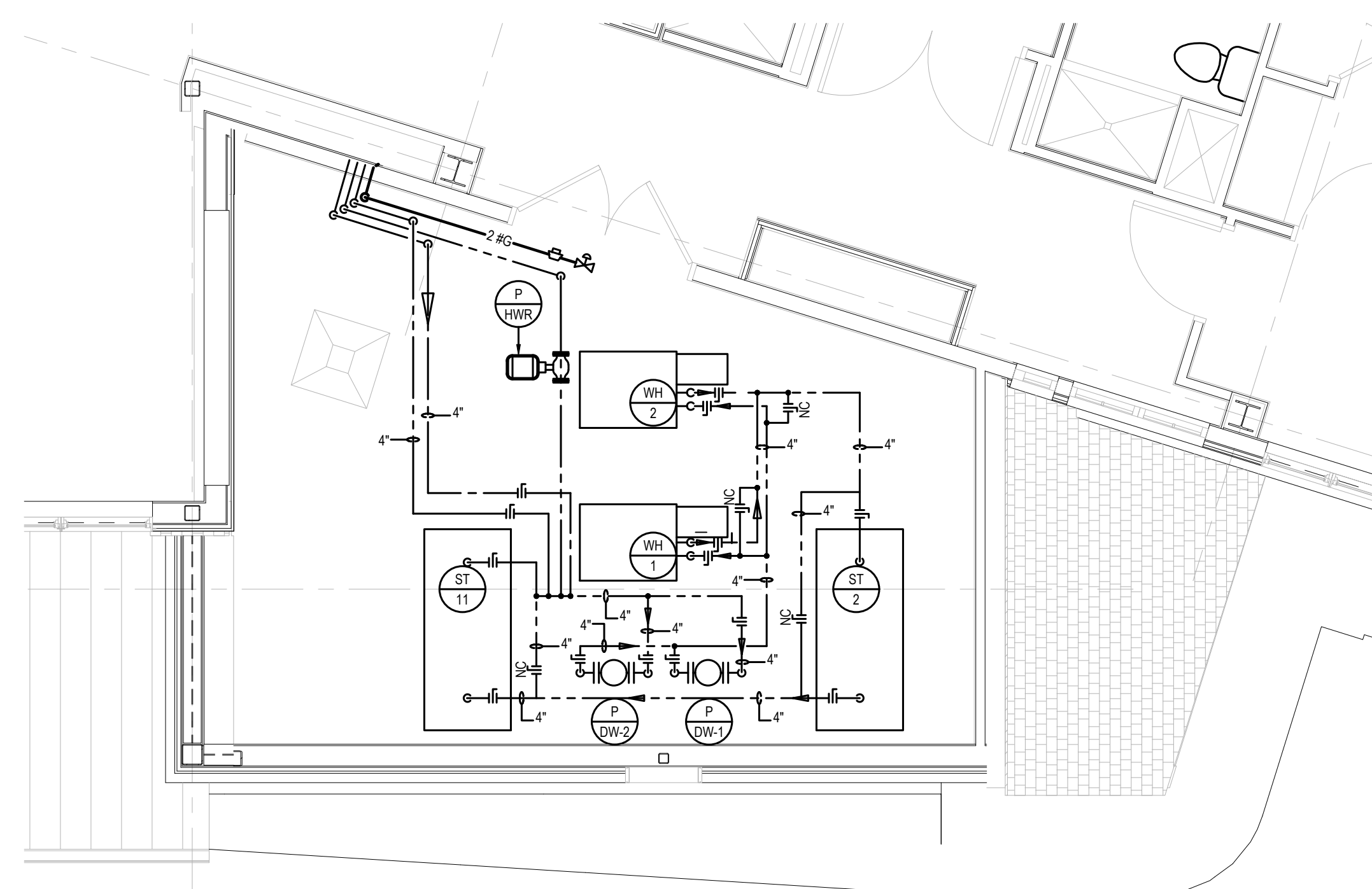

2 ENLARGED MECHANICAL ROOM PLAN

SCALE : 1/4" = 1'-0"

	ISSUE FOR CONSTRUCTION	02.28.2019
3	COMMISSIONING COMMENTS	01.23.2019
2	PERMIT SET	07.25.2018
1	90% PRICING SET	06.18.2018
MARK	REVISIONS	DATE

MEASUREMENTS AND RELATIONSHIPS MUST BE VERIFIED BY THE ARCHITECT. THE ARCHITECT IS TO BE NOTIFIED OF ANY DISCREPANCIES BEFORE PROCEEDING WITH THE CONSTRUCTION. DO NOT SCALE FROM DRAWINGS.

PROJECT #:	140145.001
FILENAME:	-
DRAWN:	WFW
CHECKED:	WFW
DATE:	07/25/18

ISSUE FOR CONSTRUCTION
02-28-2019

THIRD FLOOR
AN-PLUMBING WORK

G

D-4A