

GARAGE LEVEL

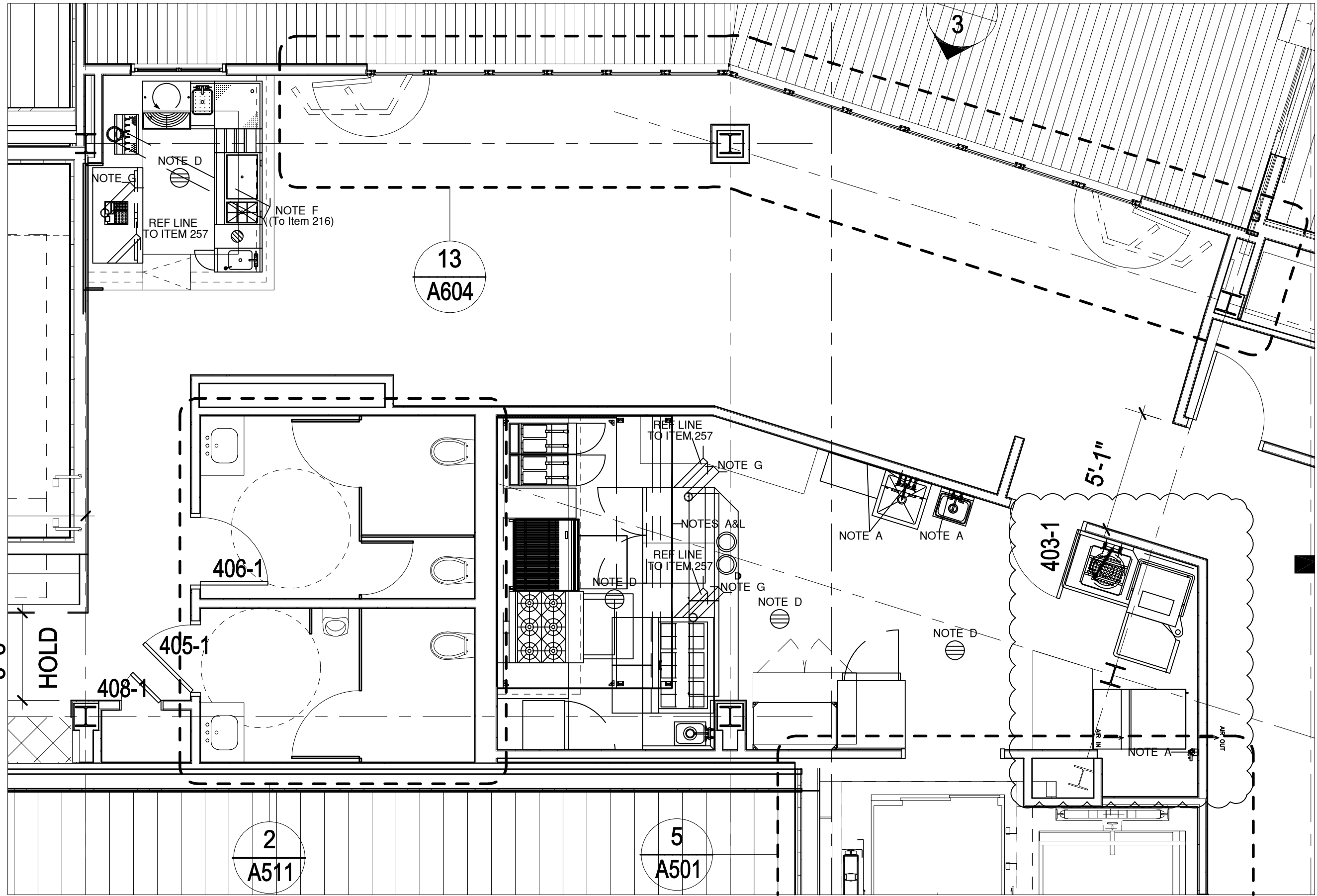

PENTHOUSE LEVEL

SPECIAL CONDITIONS NOTES

APPLICABLE ONLY WHERE SHOWN ON SPECIAL CONDITIONS PLAN

- NOTE A: CONTRACTOR TO ENSURE ALL WALLS ARE REINFORCED TO SUPPORT ALL WALL AND CEILING MOUNTED EQUIPMENT (SEE DETAIL 9).
- NOTE B: CONTRACTOR TO PROVIDE 7" DEEP DEPRESSION FROM ROUGH SLAB TO FINISHED FLOOR FOR WALK IN PANELS. DEPRESSION TO BE LEVEL AND SMOOTH (SEE DETAIL 3).
- NOTE C: CONTRACTOR TO PROVIDE 4" DEEP DEPRESSION FROM ROUGH SLAB TO FINISHED FLOOR TO RECEIVE STAINLESS STEEL FLOOR TROUGH AND GRATING. DEPRESSION TO BE LEVEL AND SMOOTH (SEE DETAIL 4).
- NOTE D: CONTRACTOR TO PITCH FLOOR TO AREA FLOOR DRAINS AT A MINIMUM OF 1/8" PER FOOT IN A 40' RADIUS FROM CENTER OF DRAIN.
- NOTE E: CONTRACTOR TO ENSURE SUFFICIENT WALL DEPTH FOR RECESSED EQUIPMENT.
- NOTE F: CONTRACTOR TO PROVIDE 6" DIAMETER CONDUIT TO RUN SODA/BEER LINES FROM SODA/BEER SYSTEMS TO POINTS SHOWN. ALL BENDS TO BE EASY SWEEPS (24" RADIUS MIN.). RUN CONDUIT ON UNDERSIDE OF SLAB OR ABOVE FINISHED CEILING AS INDICATED AND PROVIDE SUPPORT AS REQUIRED (VERIFY REQUIREMENTS WITH VENDOR).
- NOTE G: CONTRACTOR TO VERIFY EXACT DATA REQUIREMENTS FOR P.O.S. SYSTEM AND PROVIDE COMPUTER GRADE CONDUIT AS NEEDED. ALL BENDS TO BE EASY SWEEPS (18" RADIUS MIN.) FROM POINTS SHOWN TO POS SERVER LOCATION (TO BE VERIFIED WITH ARCHITECT).
- NOTE H: CONTRACTOR TO PROVIDE WALL OPENING FOR FOODSERVICE EQUIPMENT BY KEC. ALLOW 1/4" CLEARANCE PER SIDE AND PROVIDE STAINLESS STEEL TRIM STRIPS FOR ALL SIDES AS REQUIRED.
- NOTE J: CONTRACTOR TO PROVIDE REMOVABLE LOUVERED PANELS IN WALL FOR CONDENSER.
- NOTE K: CONTRACTOR TO PROVIDE HINGED ACCESS DOORS IN WALL.
- NOTE L: CONTRACTOR TO VERIFY CEILING HEIGHT TO ACCOMMODATE FOODSERVICE EQUIPMENT.

NOTE

ALL CONDUIT RUNS INDICATED FOR REFRIGERATION, DRINK AND LIQUOR SYSTEM LINES SHALL BE FURNISHED AND INSTALLED BY THE ELECTRICAL DIVISION. CONDUIT SHALL HAVE 24" (600MM) MINIMUM RADIUS BENDS.

NOTE

WHERE REFRIGERATION LINES PENETRATE PLenums AND FIRE RATED AREAS, LINES ARE TO BE HOUSED IN CONDUIT OR INSULATED AS PER APPLICABLE CODES. CONDUIT BY ELECTRICAL DIVISION AND INSULATION BY KITCHEN EQUIPMENT CONTRACTOR.

NOTE

VERIFY WITH VENDOR FOR LOCATION OF PULL BOX FOR BEER OR SODA LINE.

SPECIAL CONDITIONS LEGEND

- CONDUIT LINE RUN
- REFRIGERATION STATUS AS INDICATED
- CONDUIT STATUS AS INDICATED
- REFRIGERATION LINE RUN THROUGHOUT
- REFRIGERATED BASE
- WALL BACKING
- NON-COMBUSTIBLE WALL
- 6" (150MM) CONCRETE CURB
- FLOOR DEPRESSION

REMOTE CONDENSING UNITS

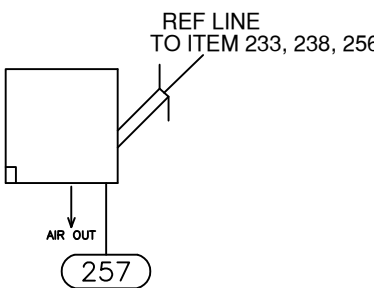

AIR COOLED, OUTDOOR - LOCATED BY ARCHITECT - Not to Scale

GENERAL NOTE (TYP. OF ALL SHEETS)

THESE DRAWINGS ARE FOR INFORMATION PURPOSES ONLY

The information conveyed in this set is intended to communicate design intent for use in the planning and bidding processes only. These documents are not for use in construction or to locate utilities or other requirements. The Kitchen Equipment Contractor and other sub-contractors are to verify all information and produce construction documents. TDO, parent company and affiliates will not be liable for action taken as a result of the design and equipment portrayed in these plans.

NIKEC: Not included in the Kitchen Equipment Contract

REVISIONS

REVISIONS