

RIVERHOUSE AT Odette's

274 SOUTH RIVER ROAD  
NEW HOPE, PA 18938

OWNER/ OPERATOR:  
GATEWAY TO NEW HOPE, LLC  
274 South River Road  
New Hope, PA 18938

ARCHITECT:  
STOKES ARCHITECTURE  
1700 Sansom Street  
Philadelphia, PA 19103  
tel: (215) 523-9190

INTERIOR DESIGNER  
BALONGUE DESIGN INC  
707 Matsonford Road  
Villanova, PA 19085  
tel: (610) 525-7593  
fax: (610) 525-7594

CIVIL ENGINEER:  
VAN CLEEF ENGINEERING  
ASSOCIATES, LLC  
501 North Main Street  
Doylestown, PA 18901  
tel: (215) 345-1876  
fax: (215) 345-1730

STRUCTURAL ENGINEER:  
O'DONNELL & NACCARATO  
111 S. Independence Mall East Suite 950  
Philadelphia, PA 19106  
tel: (215) 925-3788

MEP ENGINEER:  
WICK FISHER WHITE  
111 S. Independence Mall East Suite 400  
Philadelphia, PA 19106  
tel: (215) 627-0200  
fax: (215) 627-4540

LIGHTING DESIGNER  
BRIAN ORTER LIGHTING DESIGN LLC  
227 W. 29th St 8th Floor  
New York, NY 10001  
tel: (646) 502-7568

GENERAL NOTES

1. COORDINATE WITH STRUCTURAL DRAWINGS.
2. COORDINATE WITH THE ELECTRICAL DRAWINGS.
3. COORDINATE WITH THE CIVIL ENGINEERING DRAWINGS.
4. TRANSFORMER SPECIFIED AND SUPPLIED BY ELECTRICAL COMPANY. NOTIFY ARCHITECT IF DIMENSIONS AND/OR WEIGHT DIFFER FROM THAT SHOWN ON ARCHITECTURAL AND STRUCTURAL DRAWINGS.
5. ALL CONCRETE WALLS & COLUMNS SHALL HAVE COLD FLUID-APPLIED WATERPROOFING MEMBRANE APPLIED TO SURFACE. SEE SPECIFICATIONS SECTION 071416.
6. TOP OF TRANSFORMER PLATFORM SHALL BE ABOVE THE REGULATORY FLOOD ELEVATION.
7. CONTRACTOR, OWNER, AND ARCHITECT SHALL DISCUSS ALLOWABLE APPLIED FINISHES TO THE TRANSFORMER PAD STRUCTURE WITH THE ELECTRICAL COMPANY.
8. CONTRACTOR, OWNER, AND ARCHITECT SHALL DISCUSS THE NECESSITY OF THE STAIR WITH THE ELECTRICAL COMPANY.

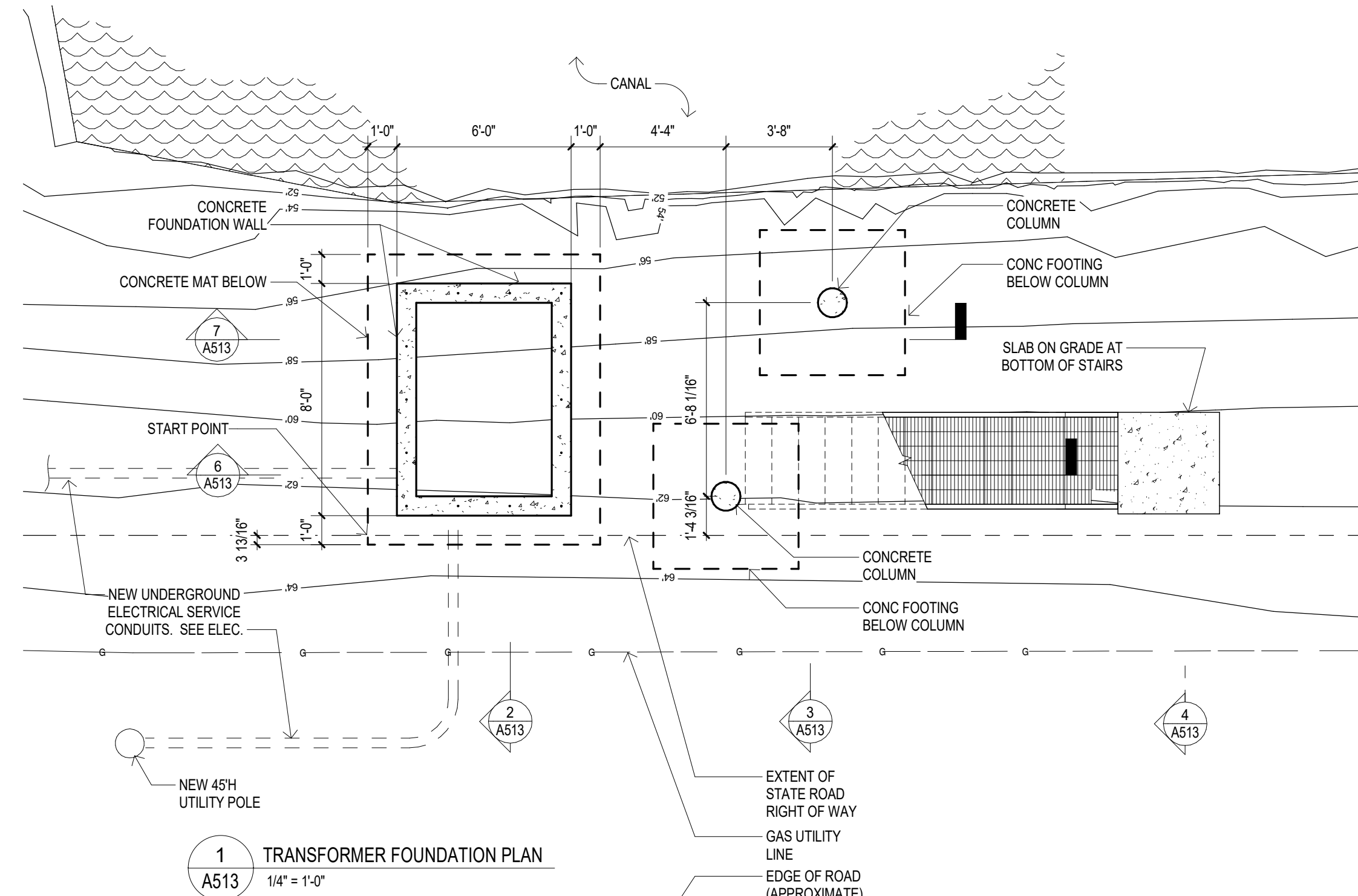
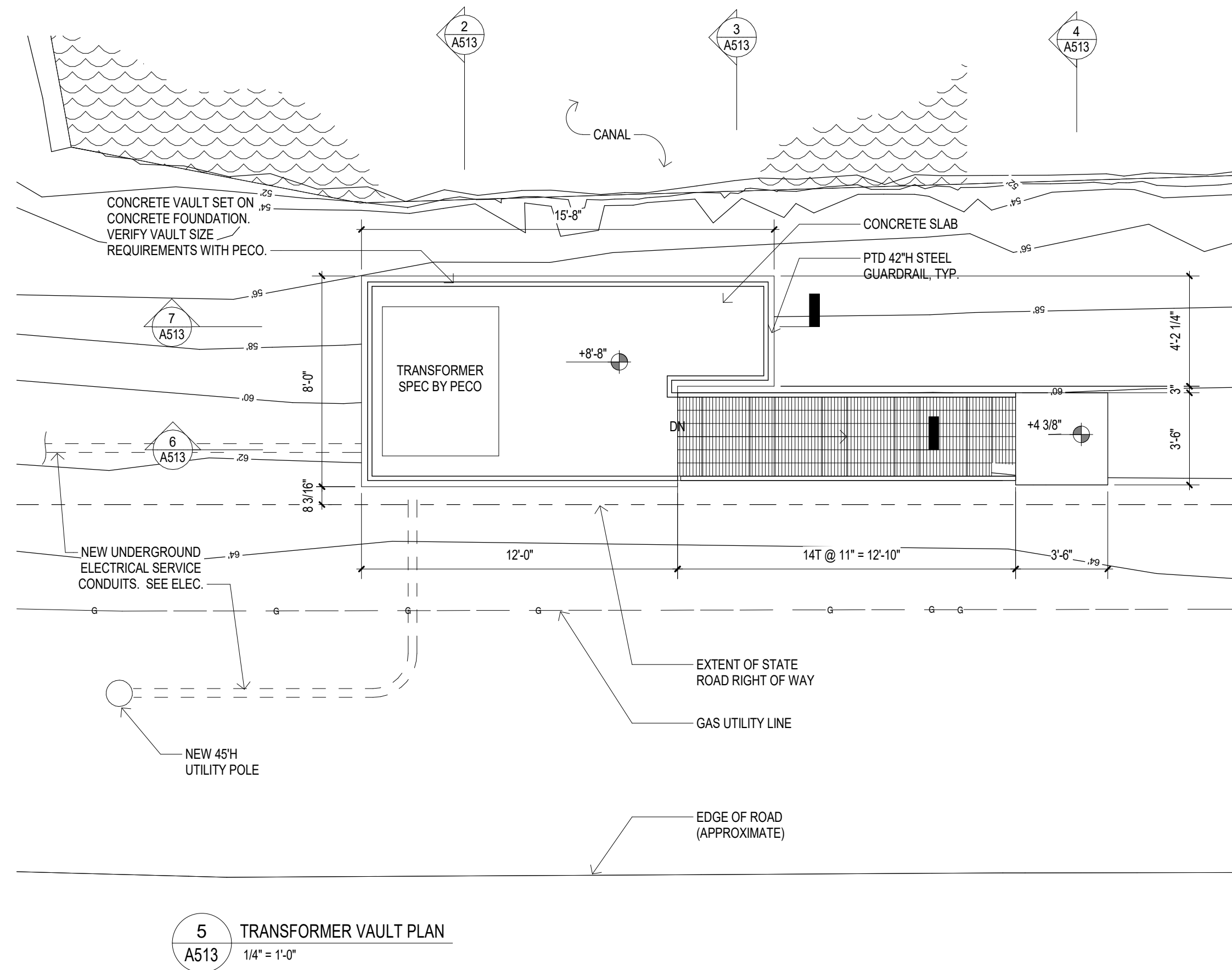
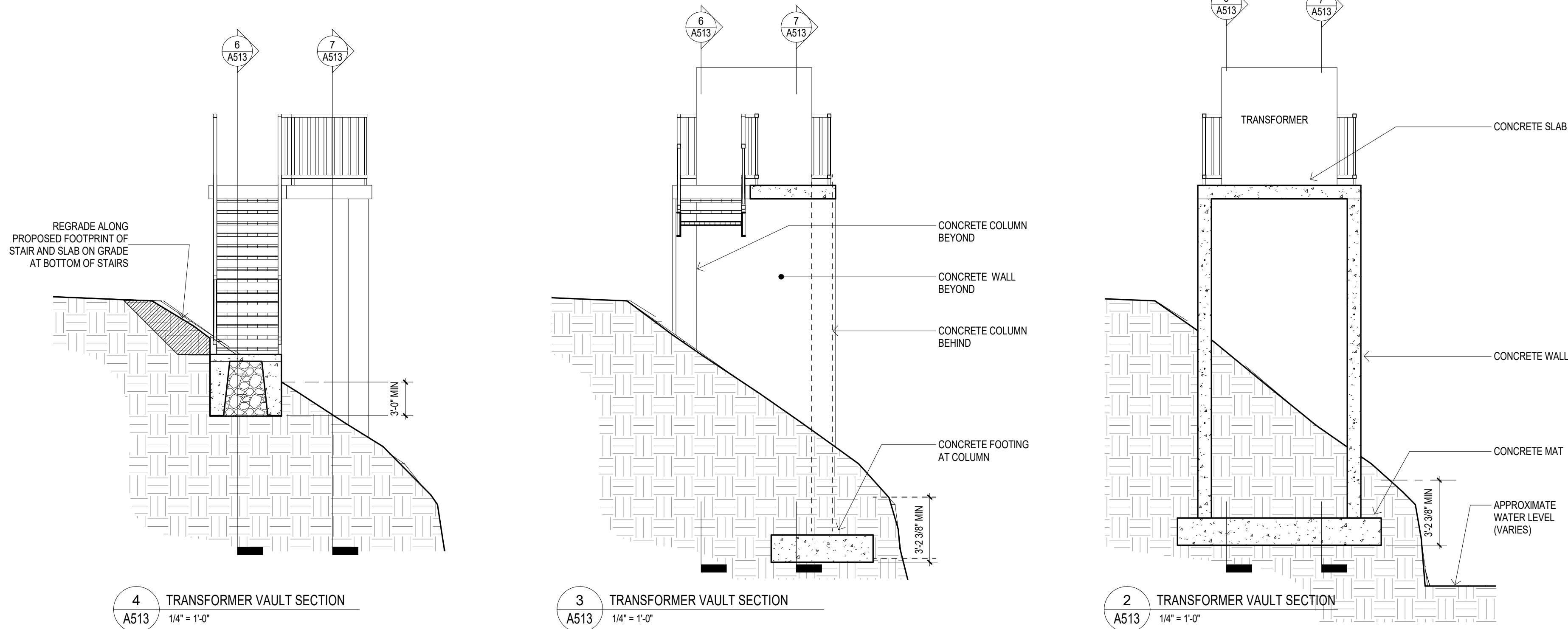
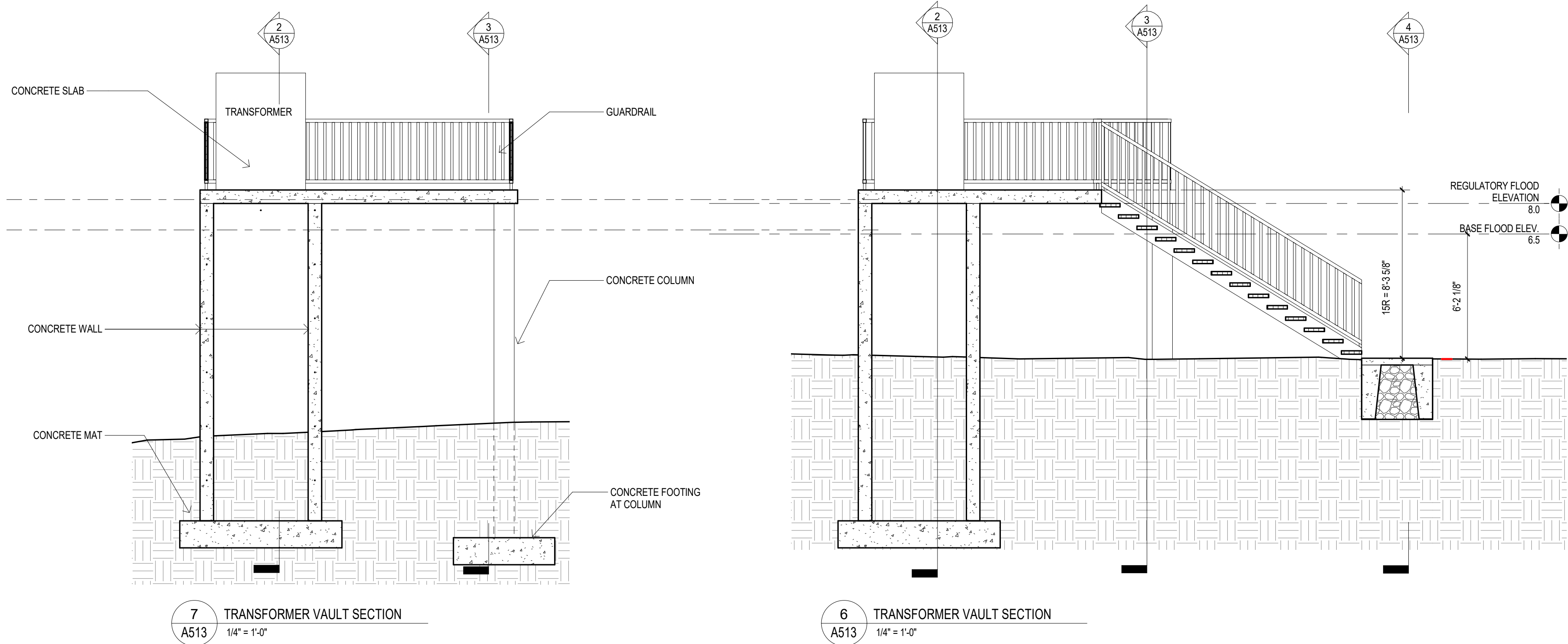

STOKES.  
ARCHITECTURE + DESIGN  
STOKESARCH.COM

SEAL

1	GENERAL REVISIONS	2019-0229
0	ISSUE FOR PERMIT	2019-0228

MARK	REVISIONS	DATE
------	-----------	------

ALL DIMENSIONS AND RELATIONSHIPS MUST BE VERIFIED BY CONTRACTOR. THE ARCHITECT IS TO BE NOTIFIED OF ANY DISCREPANCIES BEFORE PROCEEDING WITH THE CONSTRUCTION. DO NOT SCALE FROM DRAWINGS.

PROJECT #:  
FILENAME:  
DRAWN:  
CHECKED:  
DATE:

1351  
Odette's v2017.current.rvt  
JC  
RS  
2019-0228

PERMIT SET

TRANSFORMER VAULT  
PLANS AND SECTIONS

DRAWING

A513