

7 DETAIL - TYPICAL RAILING WALL-MOUNTED  
A510 3" = 1'-0"

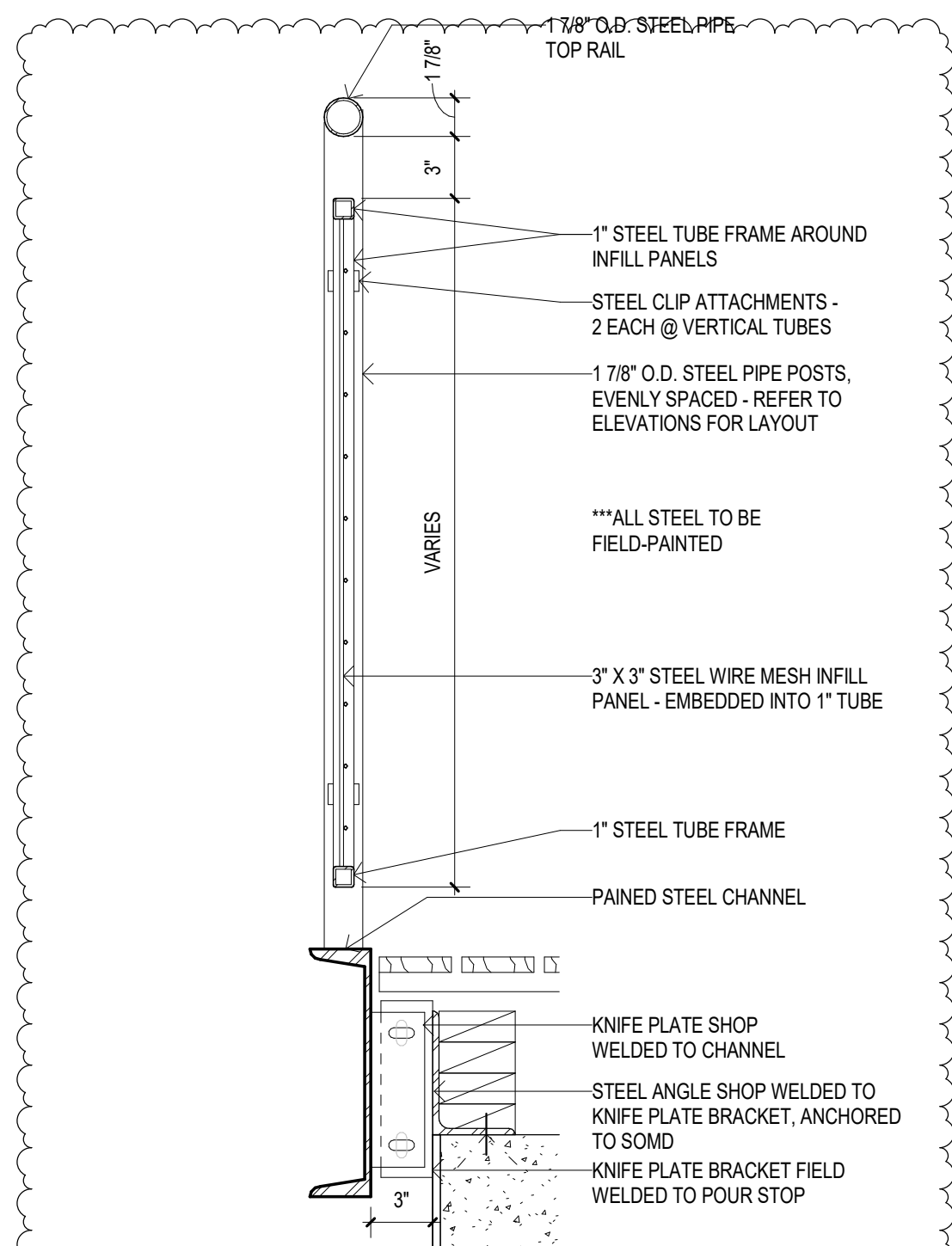

6 TYPICAL GUARDRAIL SECTION @ STEEL CHANNEL  
A510 1 1/2" = 1'-0"

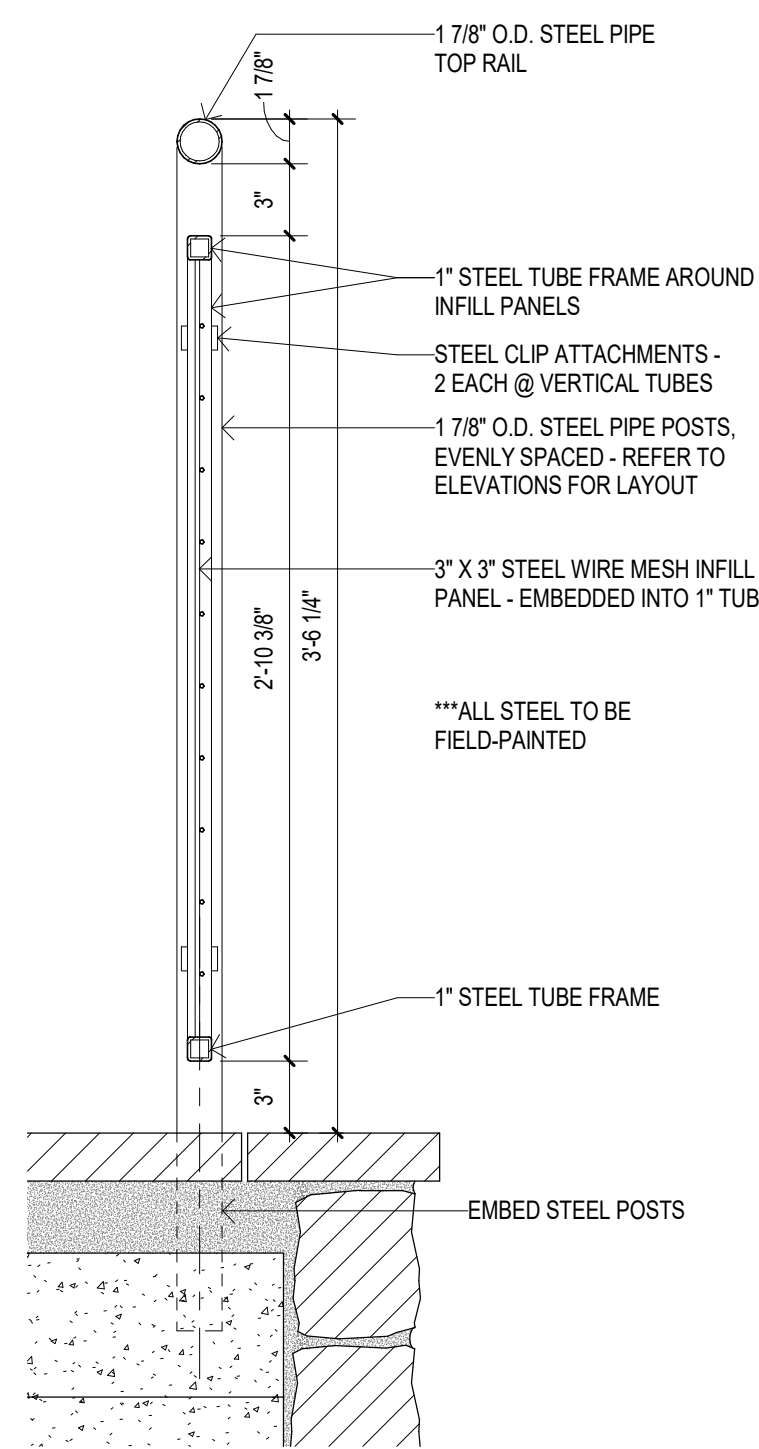

5 TYPICAL GUARDRAIL SECTION @ MASONRY WALL  
A510 1 1/2" = 1'-0"

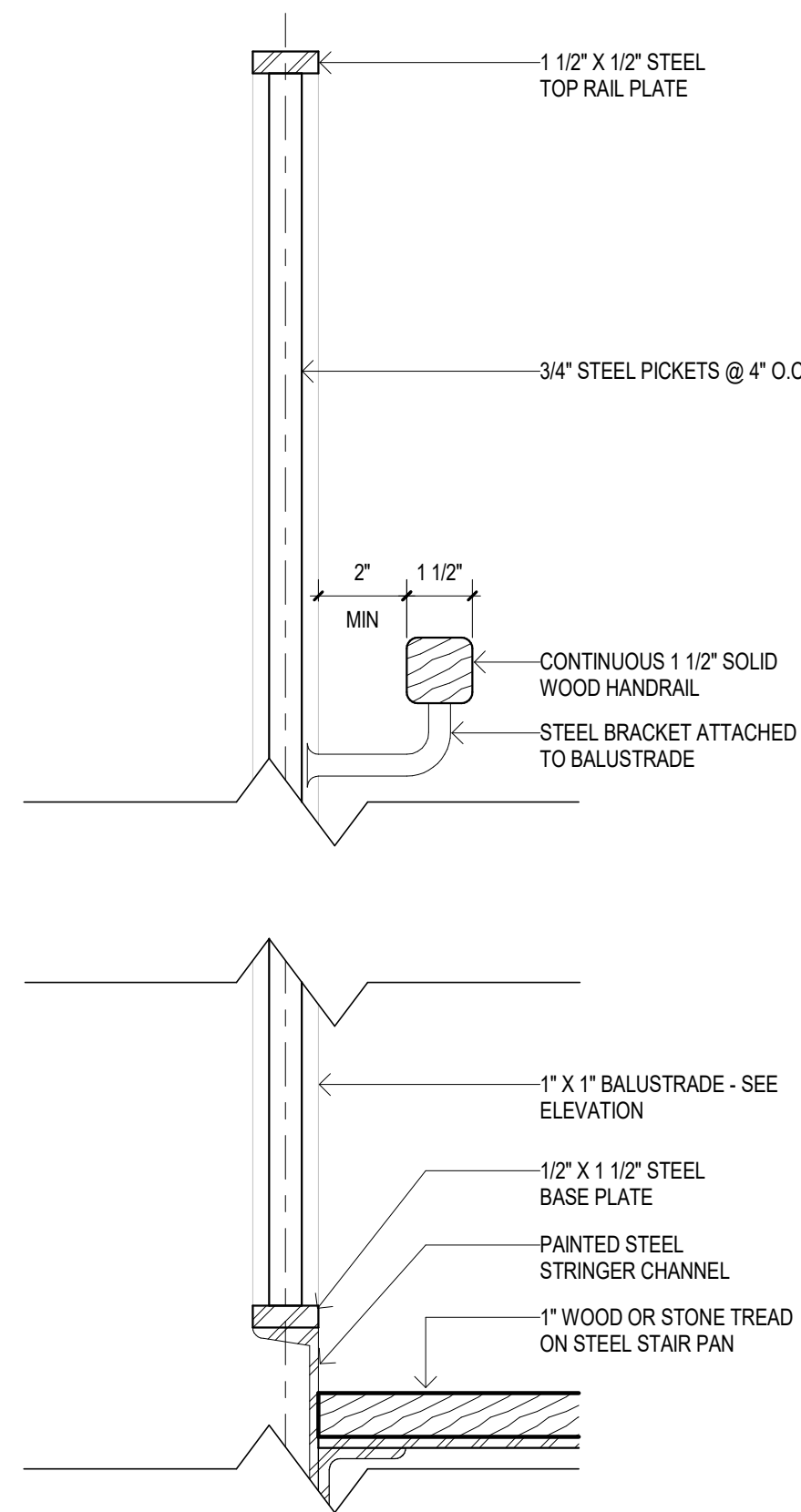

4 STAIRS - DETAIL AT RAILING - STAIRS 1  
A510 3" = 1'-0"

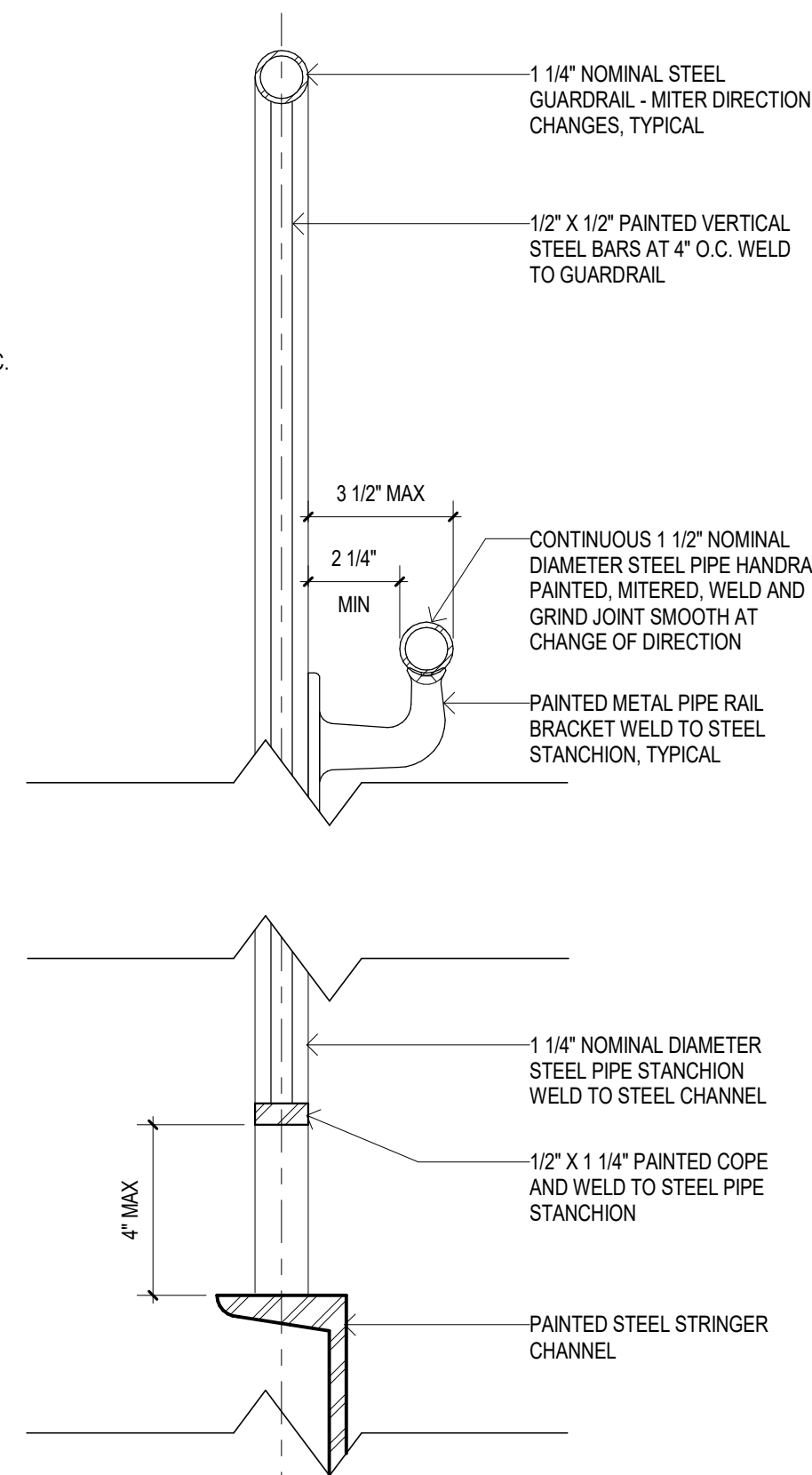

3 STAIRS - DETAIL AT RAILING - STAIRS 2  
A510 3" = 1'-0"

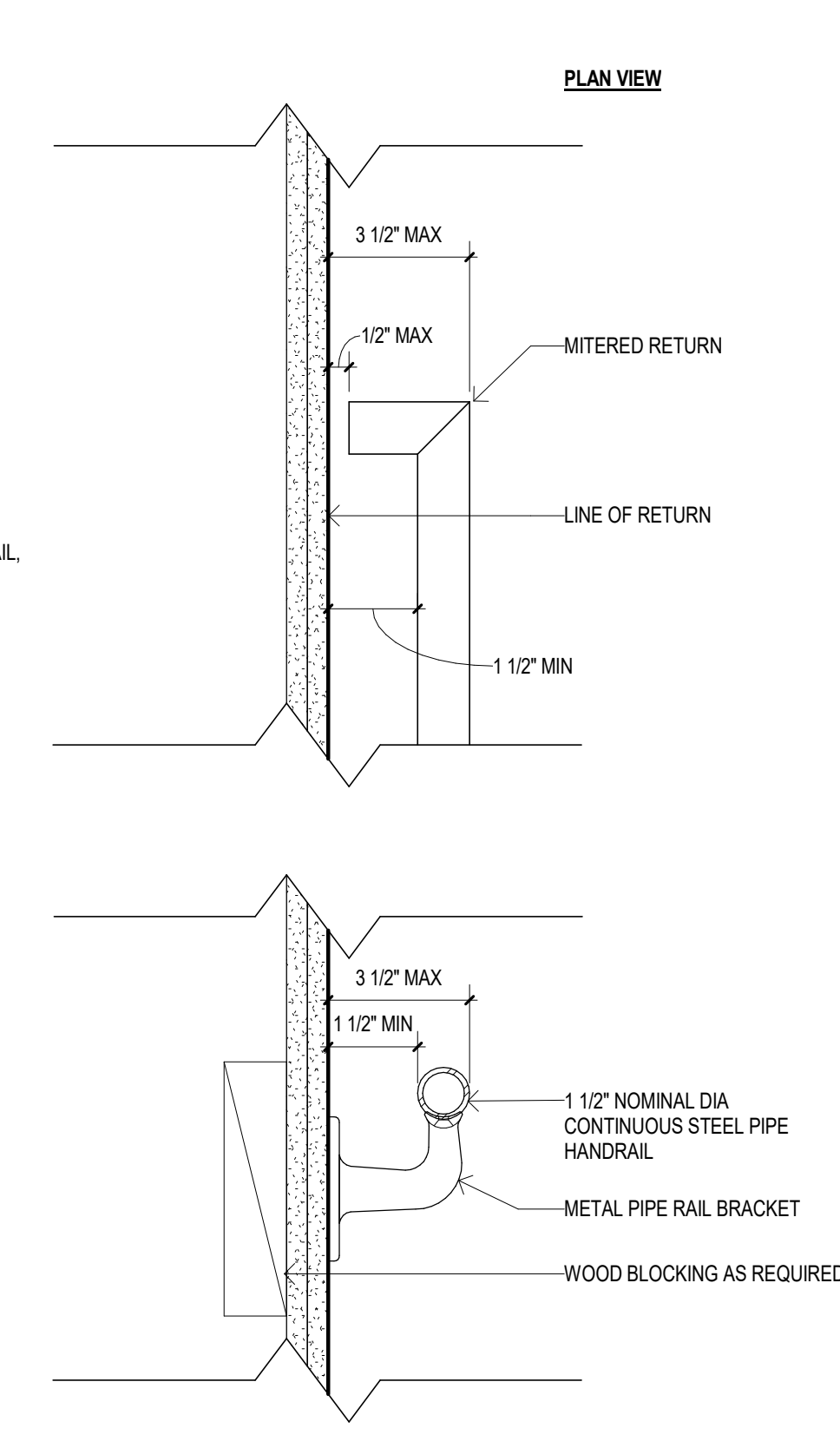

2 STAIRS - TYPICAL WALL MOUNTED HANDRAIL  
A510 3" = 1'-0"

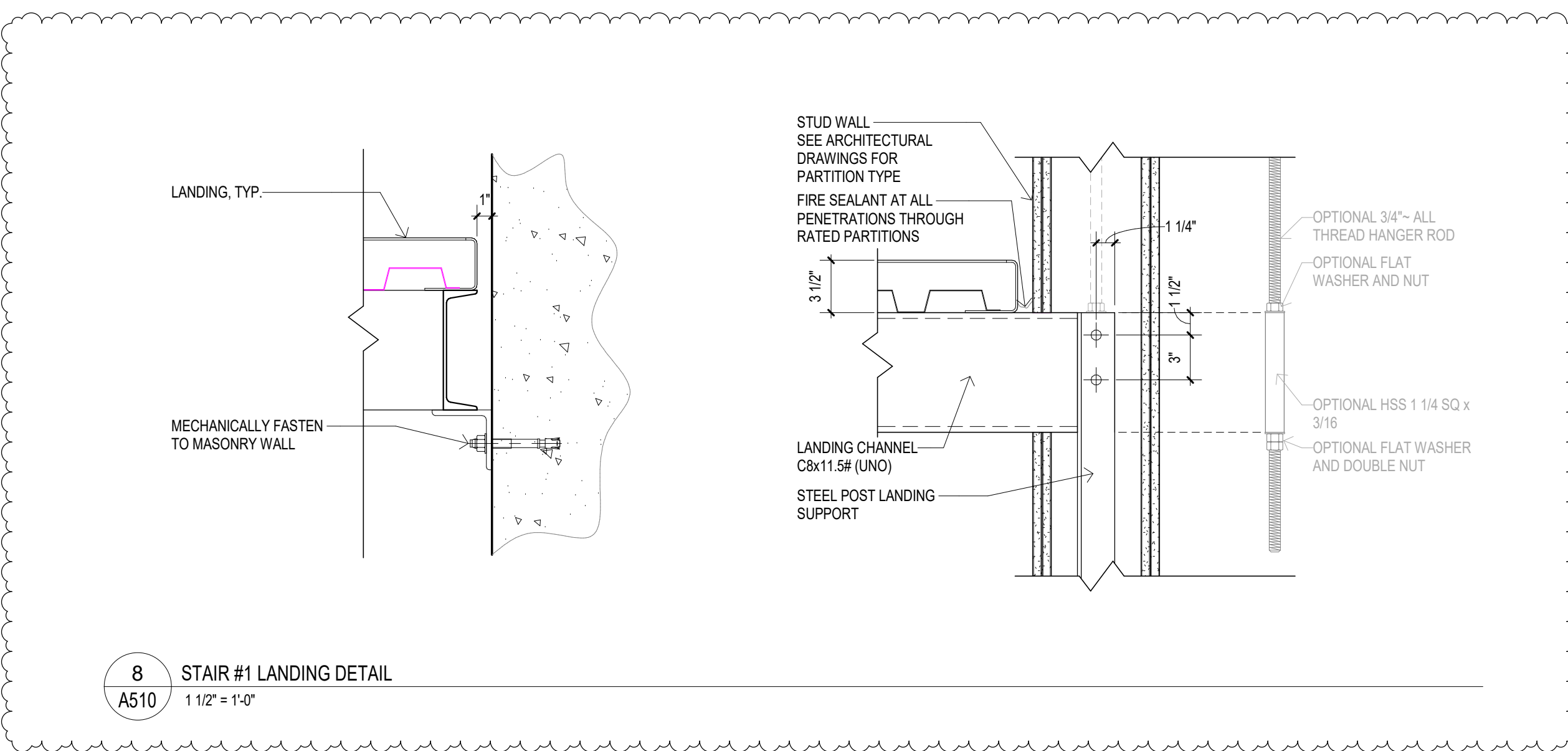

8 STAIR #1 LANDING DETAIL  
A510 1 1/2" = 1'-0"

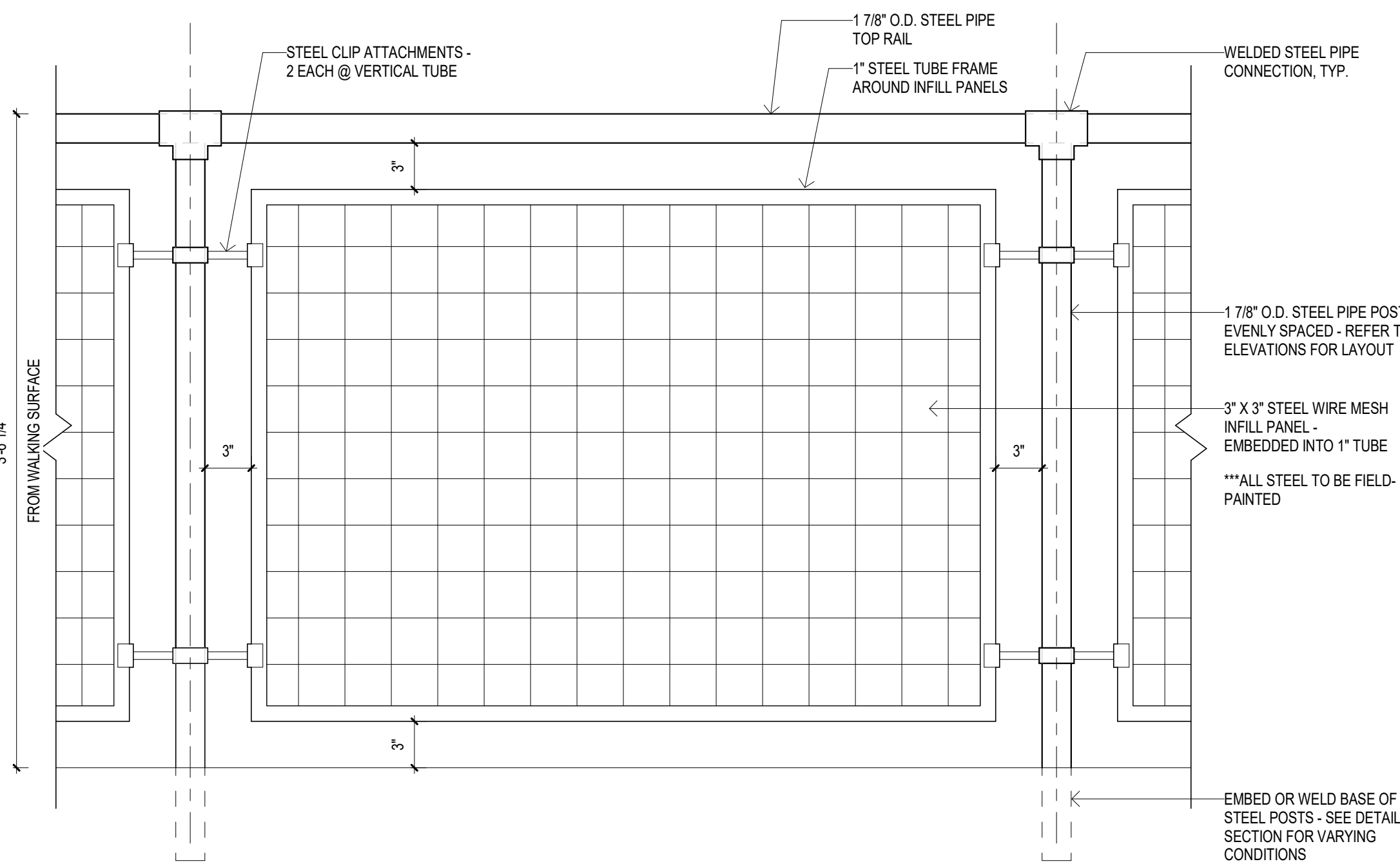

10 TYPICAL GUARDRAIL DETAIL ELEVATION  
A510 1 1/2" = 1'-0"

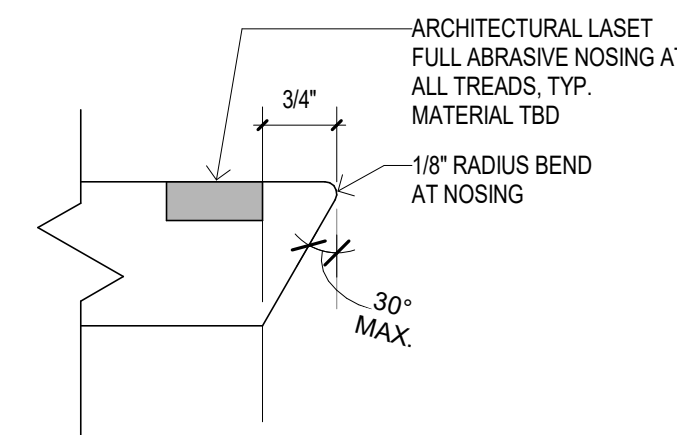

9 ENLARGED NOSING PROFILE DETAIL  
A510 6" = 1'-0"

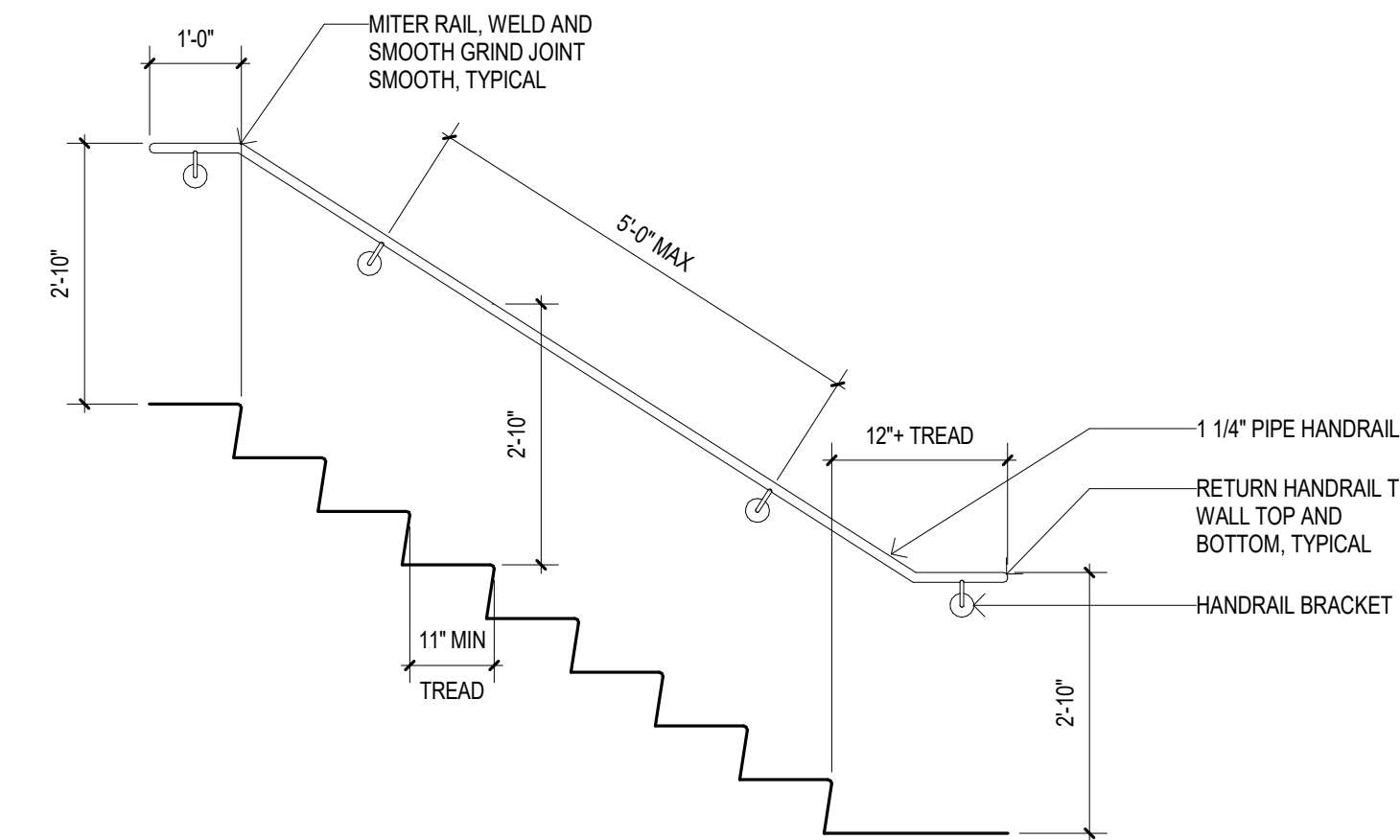

1 STAIRS - TYPICAL WALL RAIL DIAGRAM  
A510 1/2" = 1'-0"