

Roof Drain Clean-Out Detail
Not To Scale

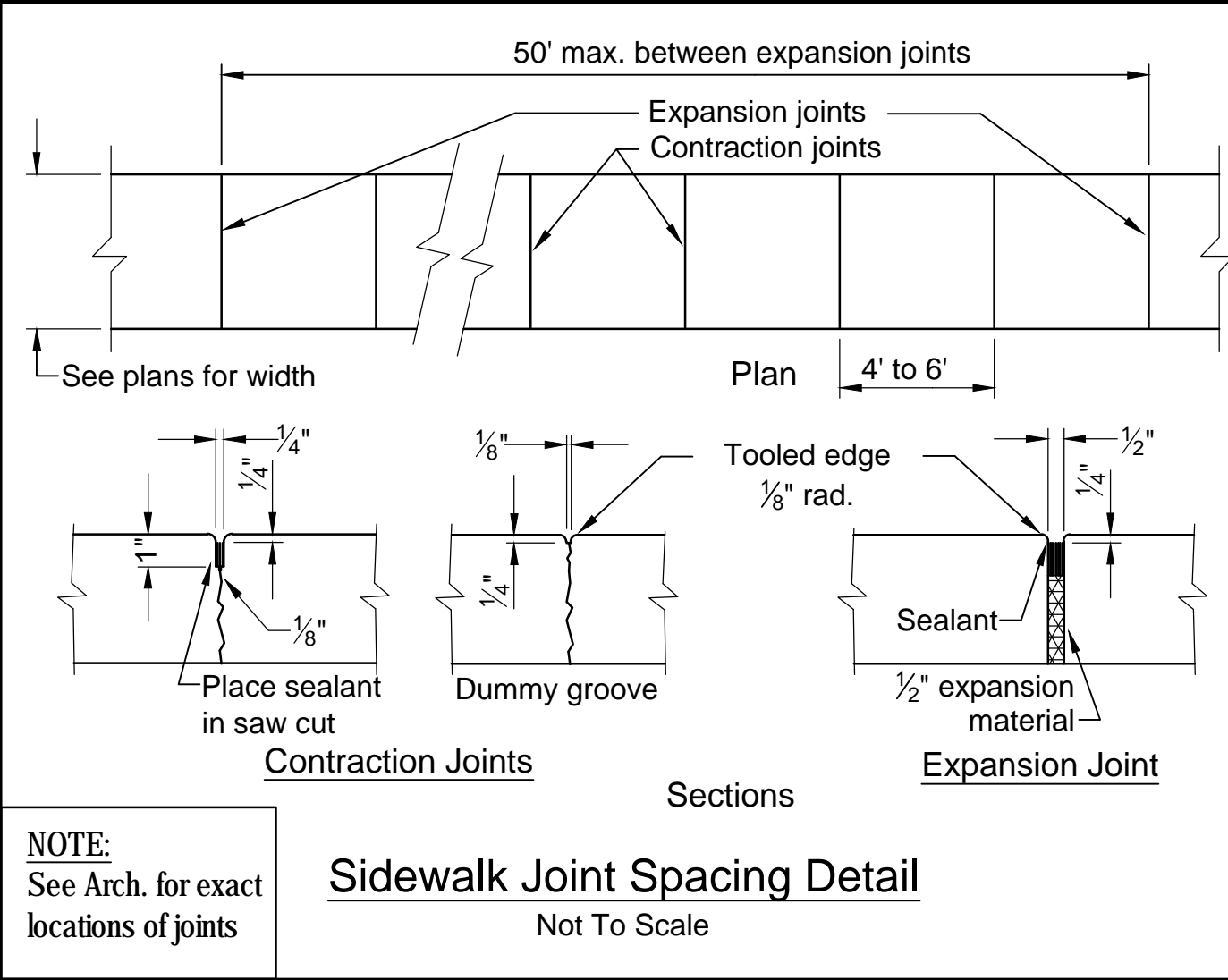

Sidewalk Joint Spacing Detail
Not To Scale

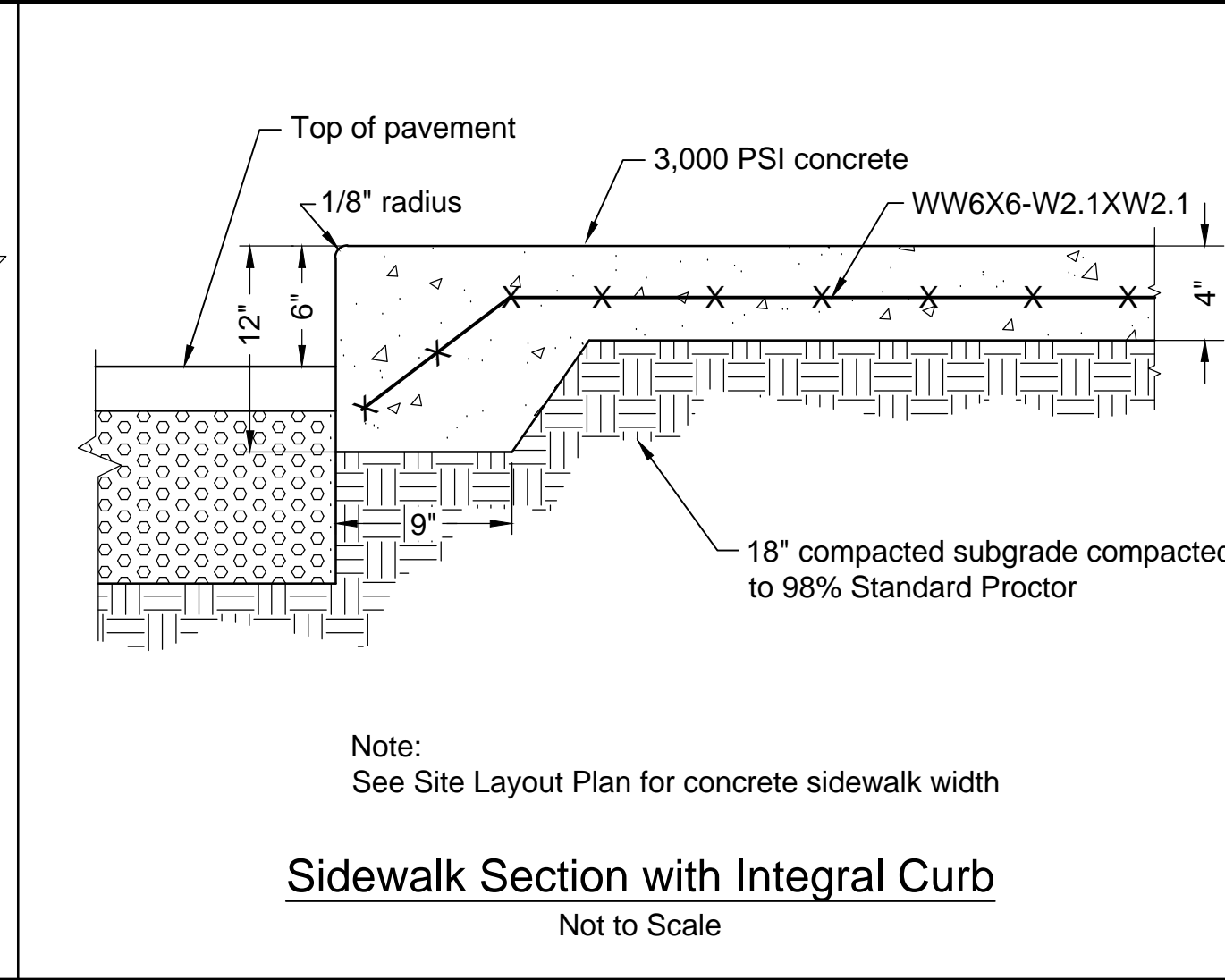

Sidewalk Section with Integral Curb
Not To Scale

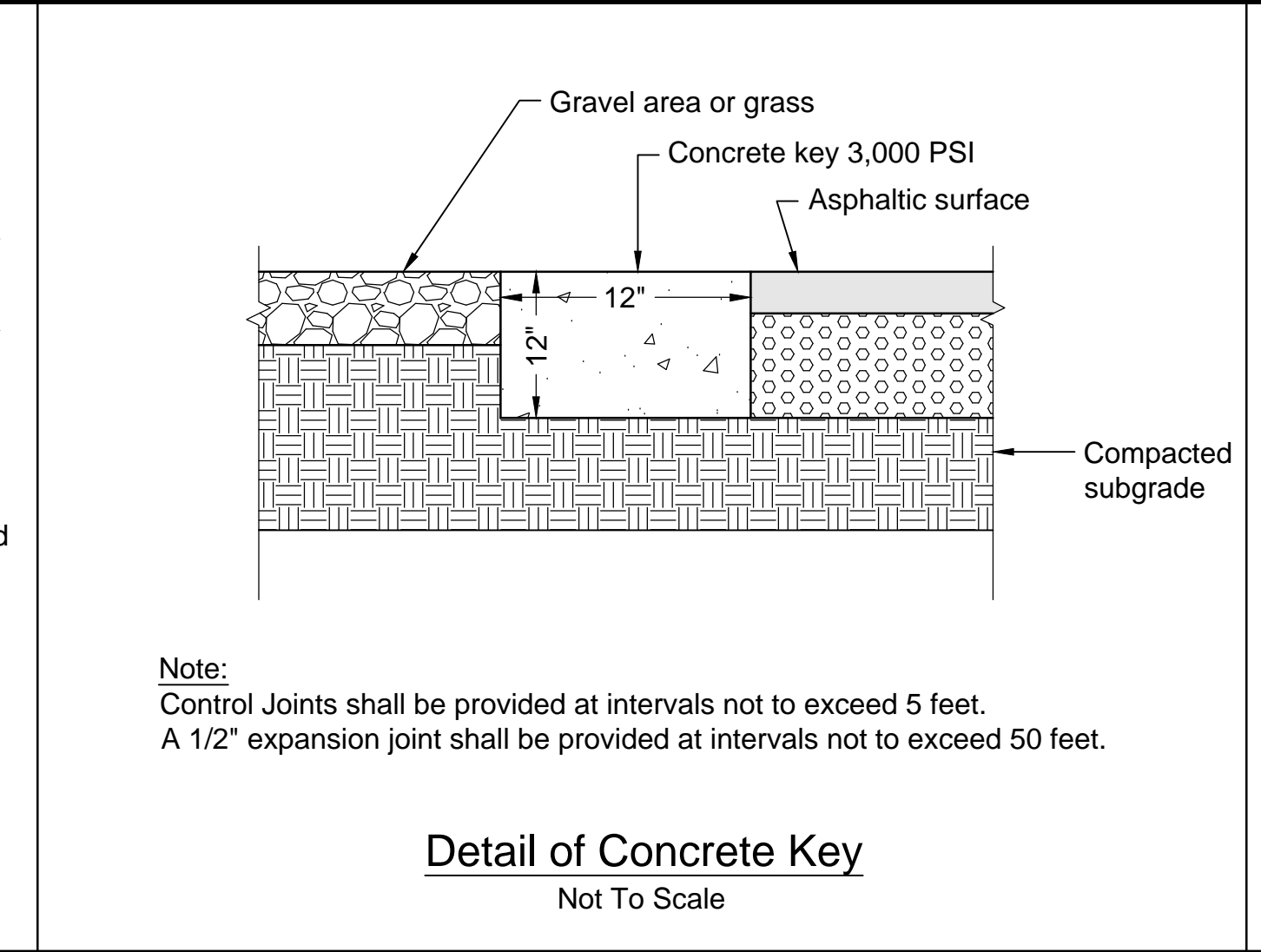

Detail of Concrete Key
Not To Scale

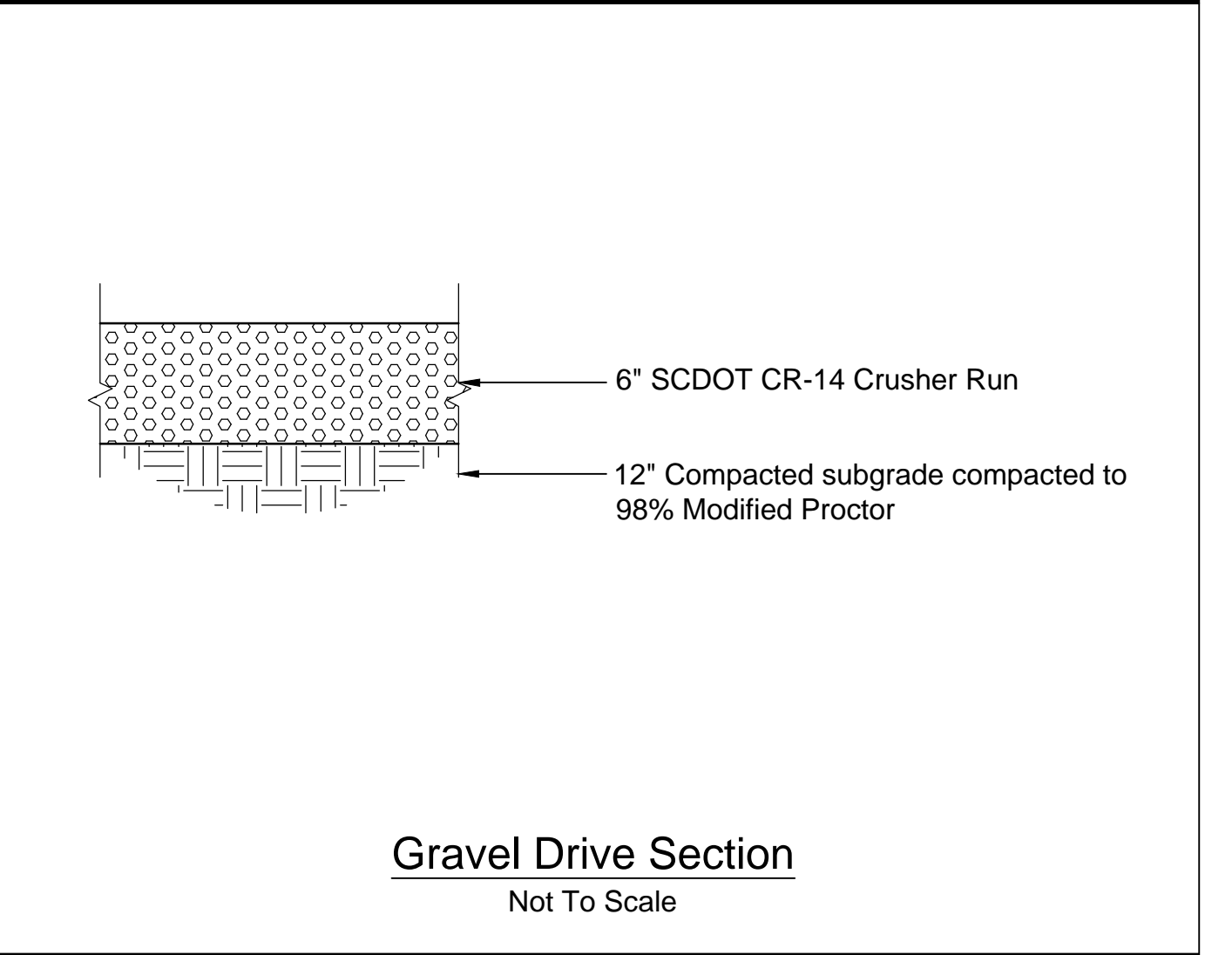

Gravel Drive Section
Not To Scale

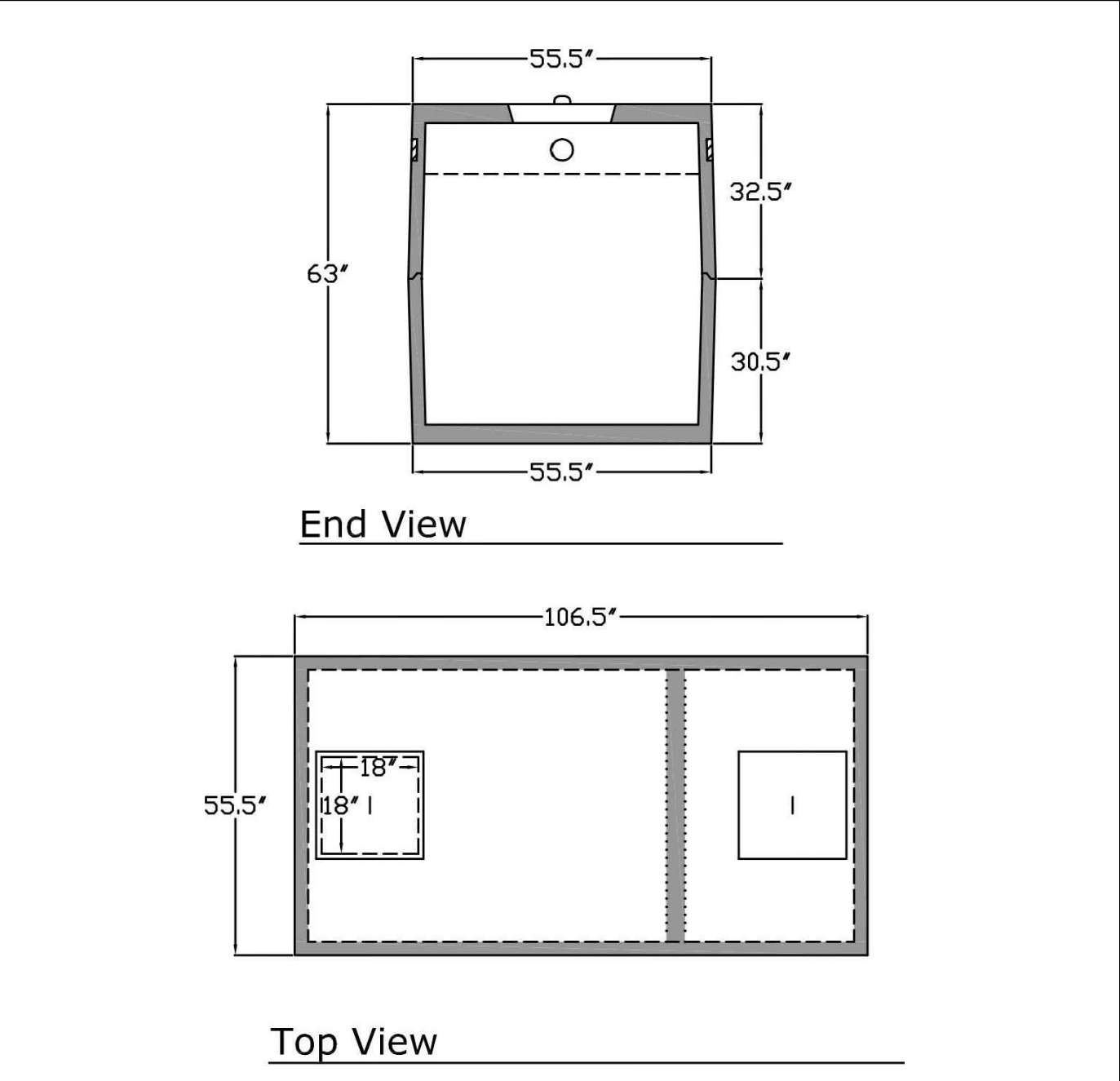

End View

Top View

- 4" inlet/outlet (standard)
- 2/3 - 1/3 compartment capacity

Both the inlet and outlet feature a high pressure pipe seal that will meet the Vacuum & Hydrostatic pressure requirements of A.S.T.M. spec. C-923 for 2", 3" & 4" SCH-40.

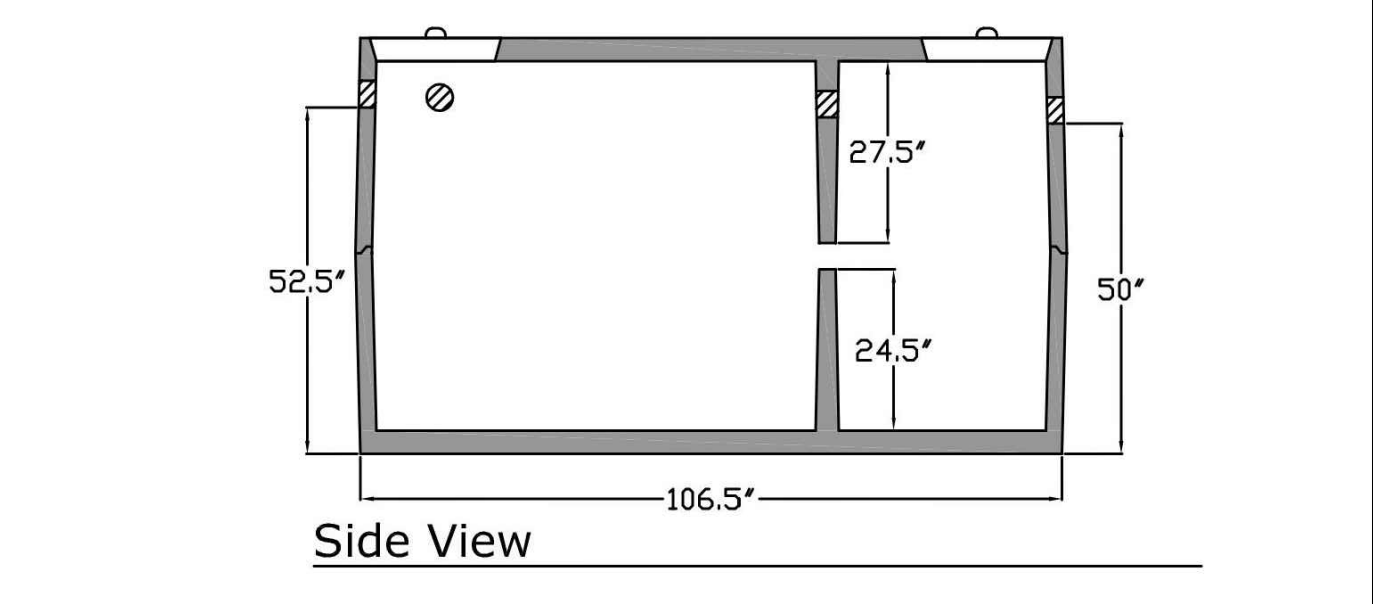

Side View

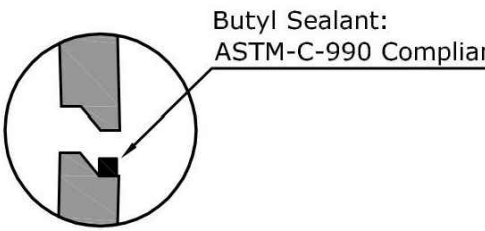

Specifications
Concrete: 5,000 psi minimum strength (28 day)
Reinforcing: Primary reinforcement will be rebar.
Risers: Grade rings and manhole frames and covers sold separately.
Sealant: Sealant used in the seam of the tank will meet or exceed ASTM C990.
Pipe Penetrations: Inlet and outlets are fitted with seals that meet or exceed all ASTM C923 specifications.
Partition Wall: The partition wall, if present, is poured monolithically.
Watertight: ASTM C 1227 latest revision. Tank must be tested within 3 working days of delivery.
Drawing: All measurements are accurate within ± 1 inch.
Installation: The tank hole is not to be more than 1.8 in. longer and wider than the tank. There shall be a minimum of 6" of 3/4" stone bedding. Do not install across path of vehicles or heavy equipment. This tank is designed for one hundred fifty pounds per square foot (150 lb/ft2) uniform loading on the top of the tank with a max backfill cover of 36" and a minimum of 6".

1,000-Gal Septic Tank

Not to scale
Basis of Design: C.R. Barger & Sons, or approved equal

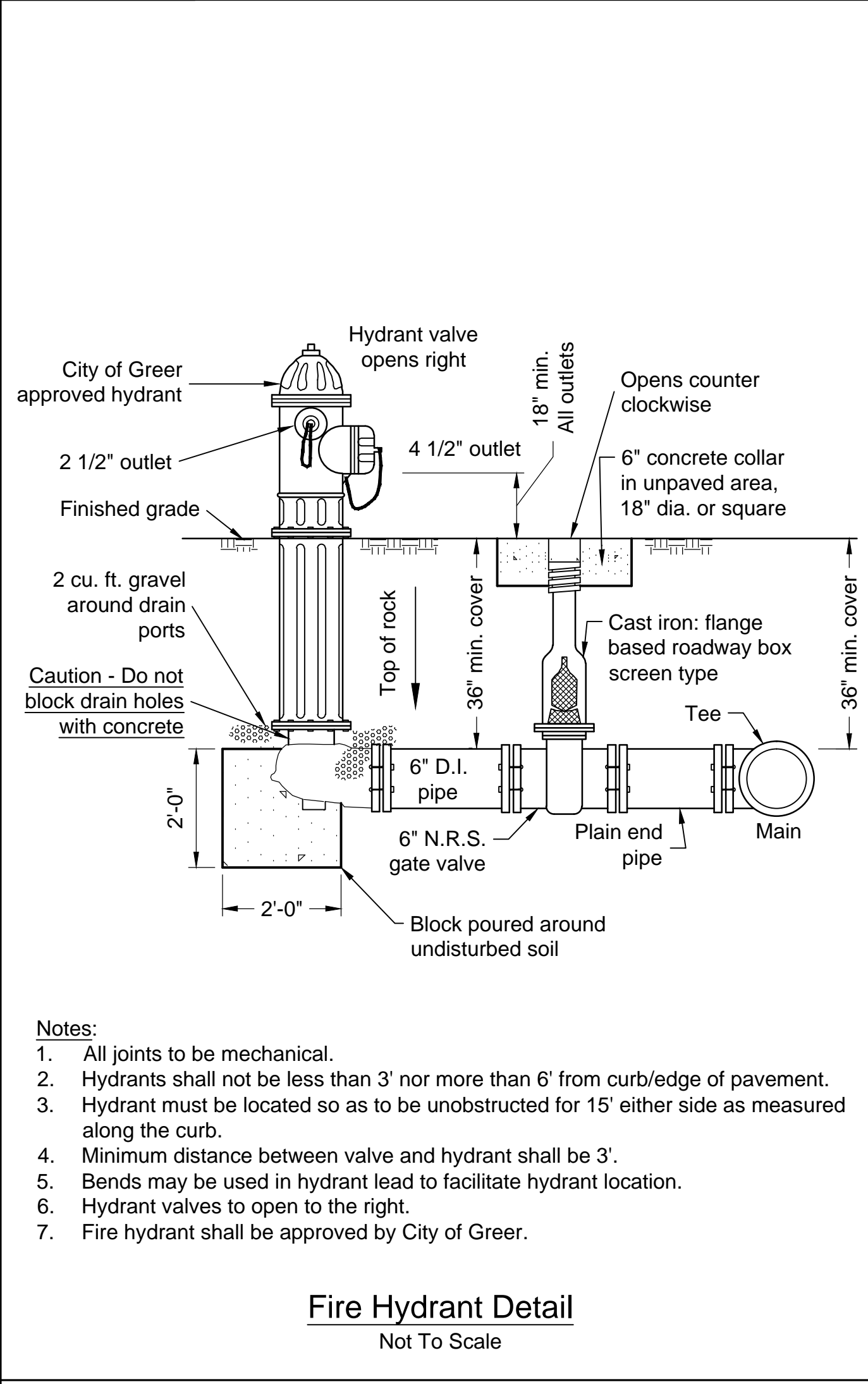

Fire Hydrant Detail
Not To Scale

- Notes:
- All joints to be mechanical.
 - Hydrants shall not be less than 3' nor more than 6' from curb/edge of pavement.
 - Hydrant must be located so as to be unobstructed for 15' either side as measured along the curb.
 - Minimum distance between valve and hydrant shall be 3'.
 - Bends may be used in hydrant lead to facilitate hydrant location.
 - Hydrant valves to open to the right.
 - Fire hydrant shall be approved by City of Greer.

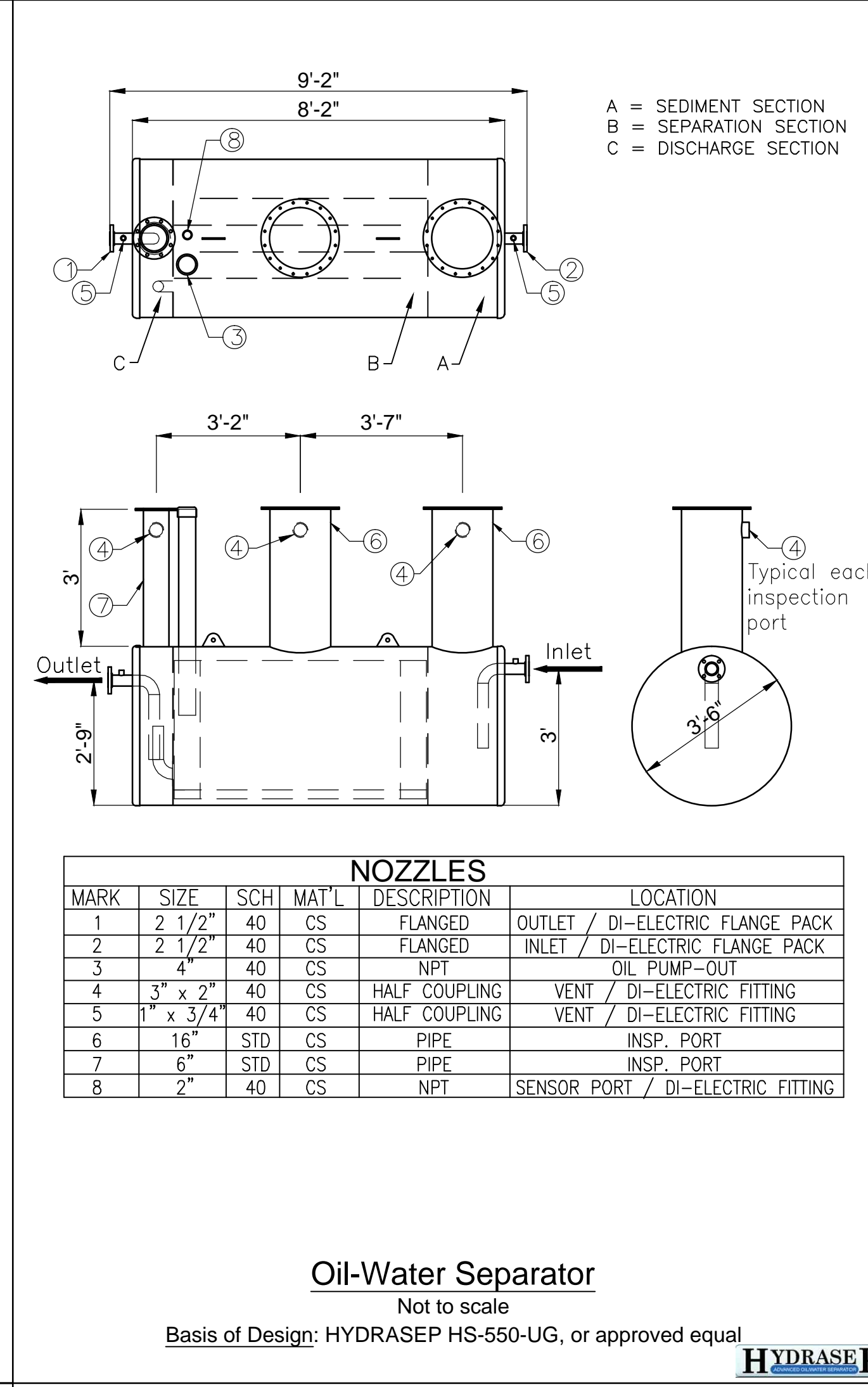

Oil-Water Separator
Not to scale

Basis of Design: HYDRASEP HS-550-UG, or approved equal

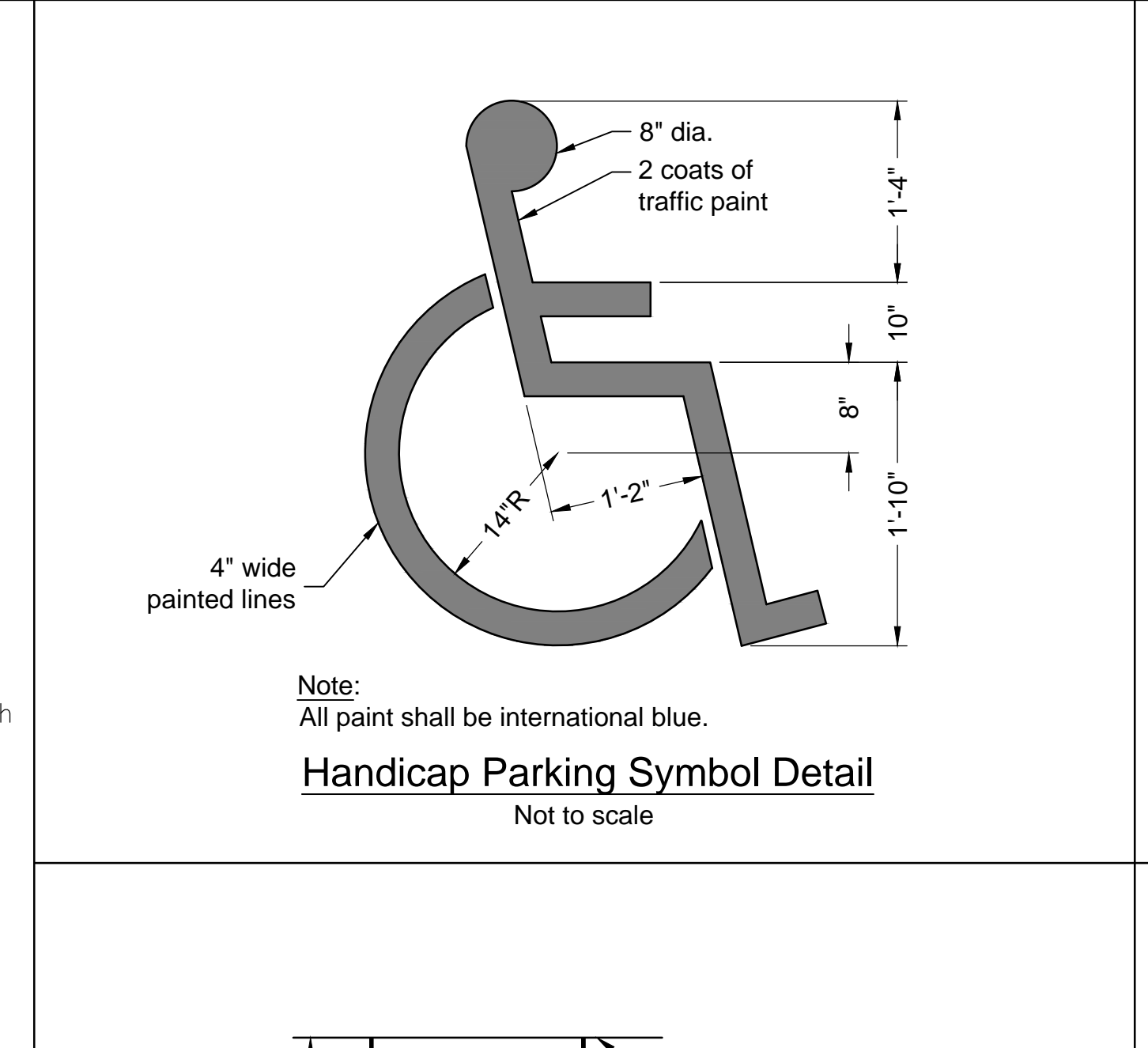

Handicap Parking Symbol Detail
Not to scale

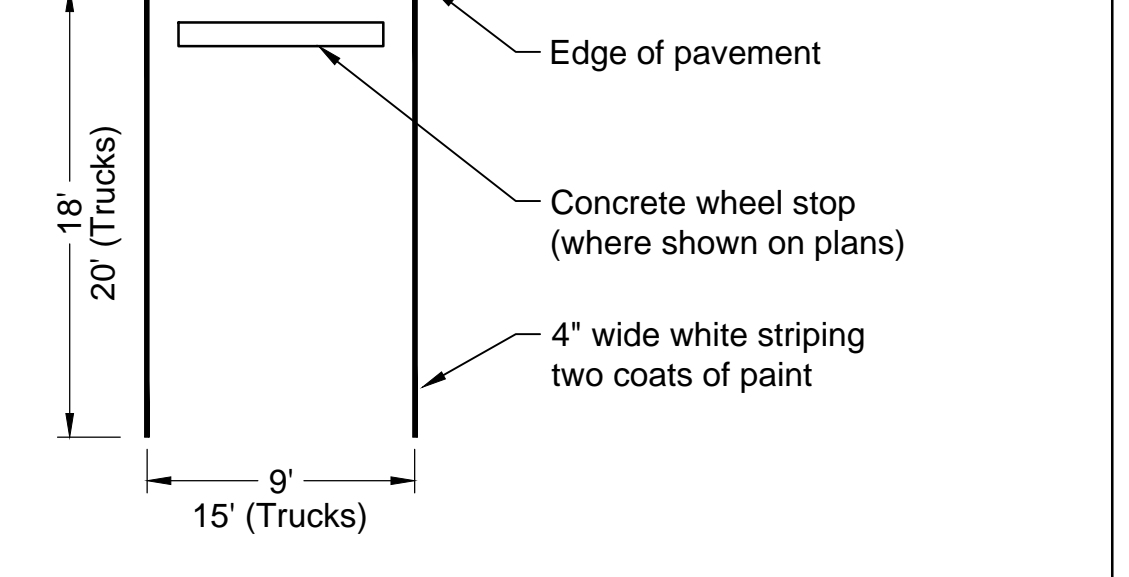

Parking space layout
Not To Scale

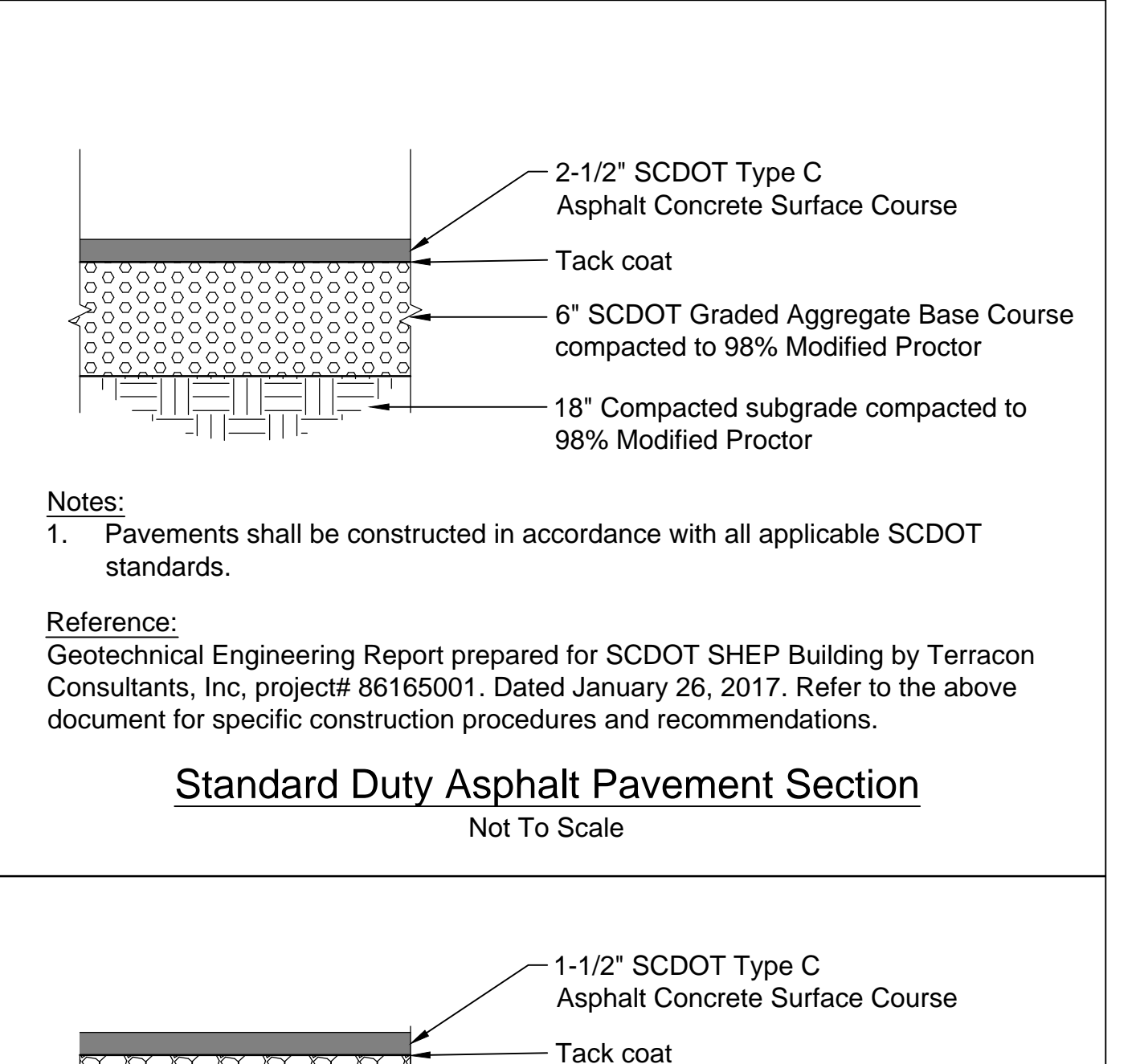

Standard Duty Asphalt Pavement Section
Not To Scale

- Notes:
- Pavements shall be constructed in accordance with all applicable SCDOT standards.

Reference: Geotechnical Engineering Report prepared for SCDOT SHEP Building by Terracon Consultants, Inc. project# 86165001. Dated January 26, 2017. Refer to the above document for specific construction procedures and recommendations.

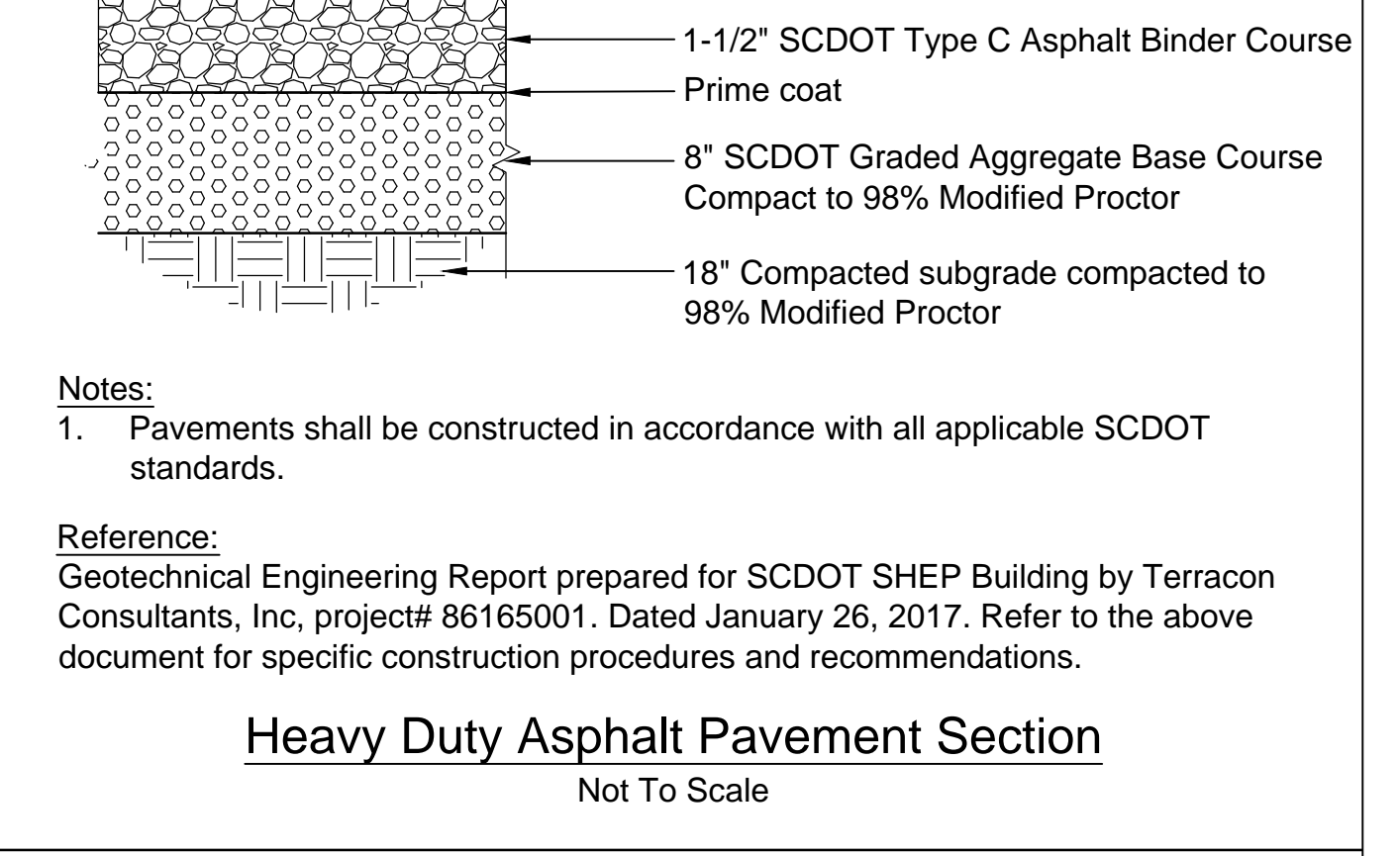

Heavy Duty Asphalt Pavement Section
Not To Scale

- Notes:
- Pavements shall be constructed in accordance with all applicable SCDOT standards.

Reference: Geotechnical Engineering Report prepared for SCDOT SHEP Building by Terracon Consultants, Inc. project# 86165001. Dated January 26, 2017. Refer to the above document for specific construction procedures and recommendations.

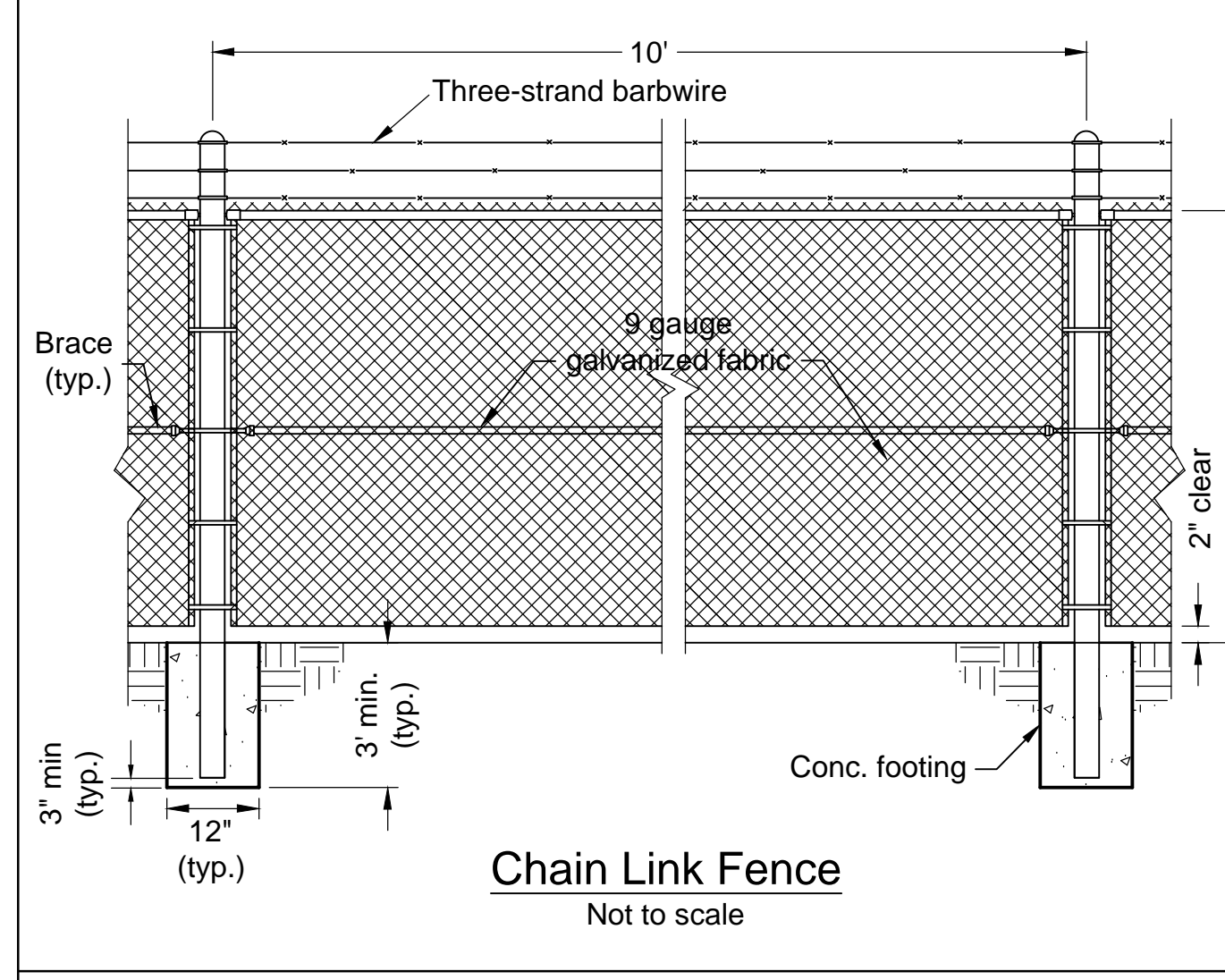

Chain Link Fence
Not to scale

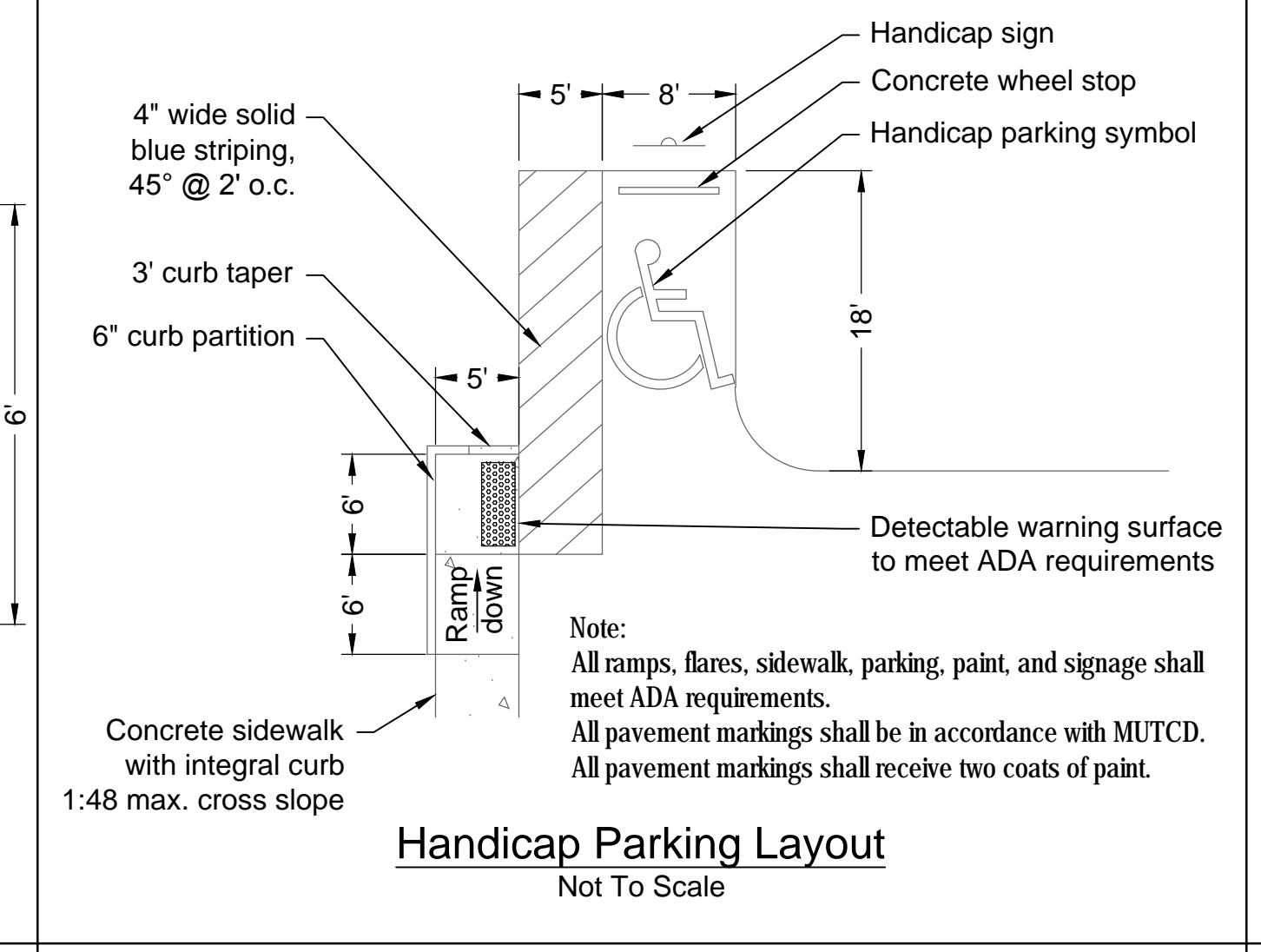

Handicap Parking Layout
Not To Scale

Note: All mmps, flares, sidewalk, parking, paint, and signage shall meet ADA requirements. All pavement markings shall be in accordance with MUTCD. All pavement markings shall receive two coats of paint.

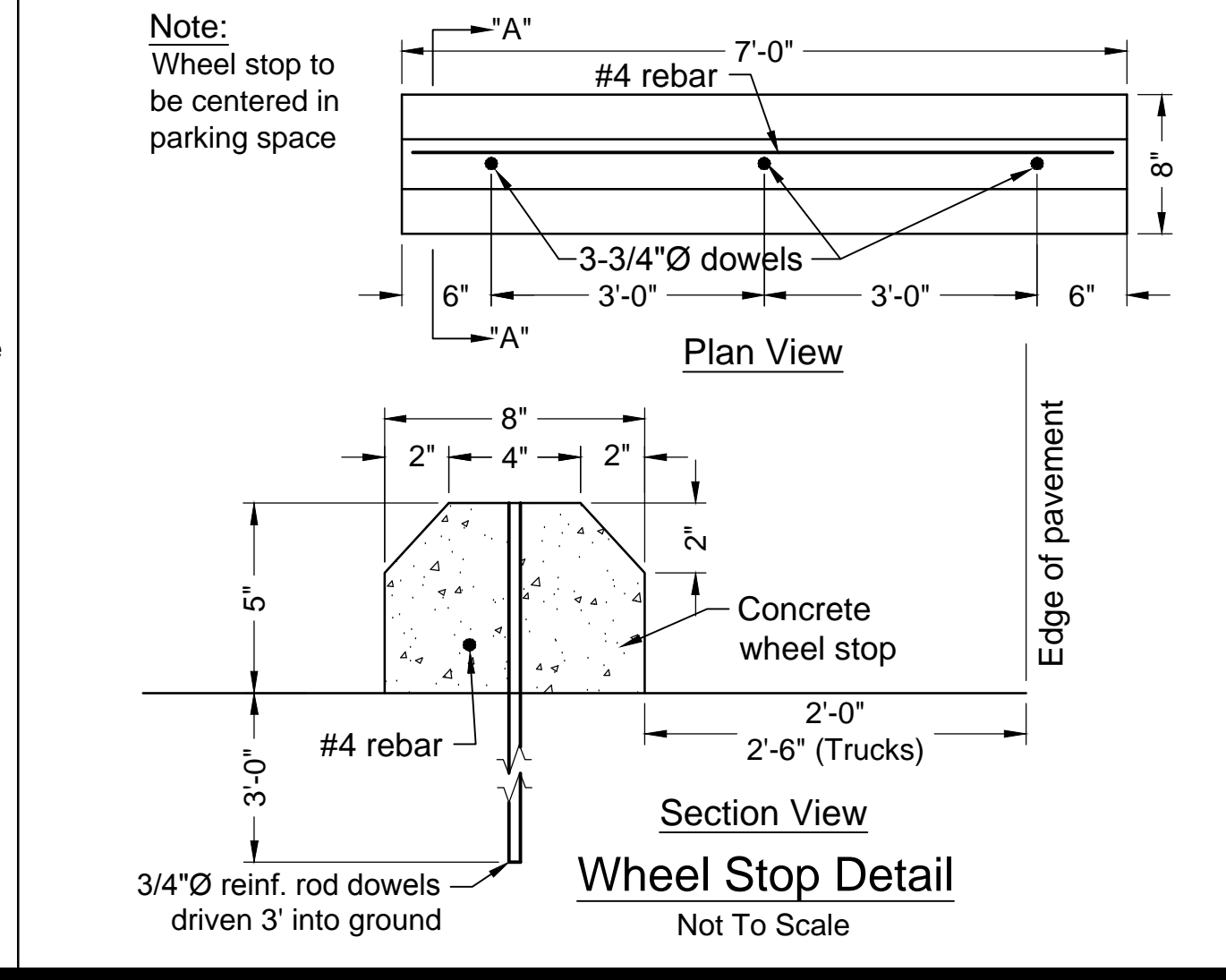

Wheel Stop Detail
Not To Scale

Note: Wheel stop to be centered in parking space

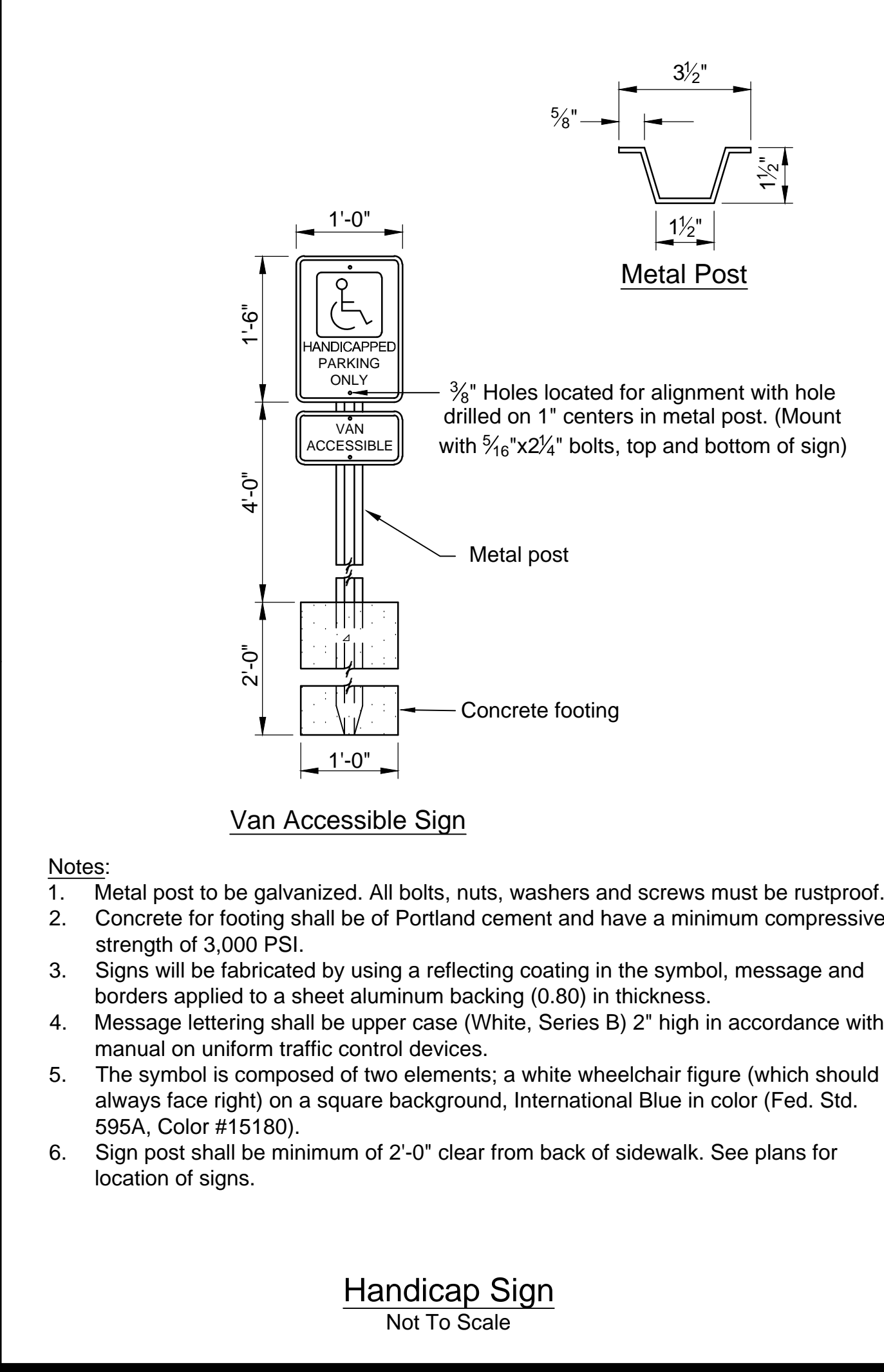

Van Accessible Sign

Handicap Sign
Not To Scale

- Notes:
- Metal post to be galvanized. All bolts, nuts, washers and screws must be rustproof.
 - Concrete for footing shall be of Portland cement and have a minimum compressive strength of 3,000 PSI.
 - Signs will be fabricated by using a reflecting coating in the symbol, message and borders applied to a sheet aluminum backing (0.80) in thickness.
 - Message lettering shall be upper case (White, Series B) 2" high in accordance with manual on uniform traffic control devices.
 - The symbol is composed of two elements, a white wheelchair figure (which should always face right) on a square background, International Blue in color (Fed. Std. 595A, Color #15180).
 - Sign post shall be minimum of 2'-0" clear from back of sidewalk. See plans for location of signs.

Drawing file: 57793C.dwg
 Pictet: Jul 21, 2017 - 1:08pm

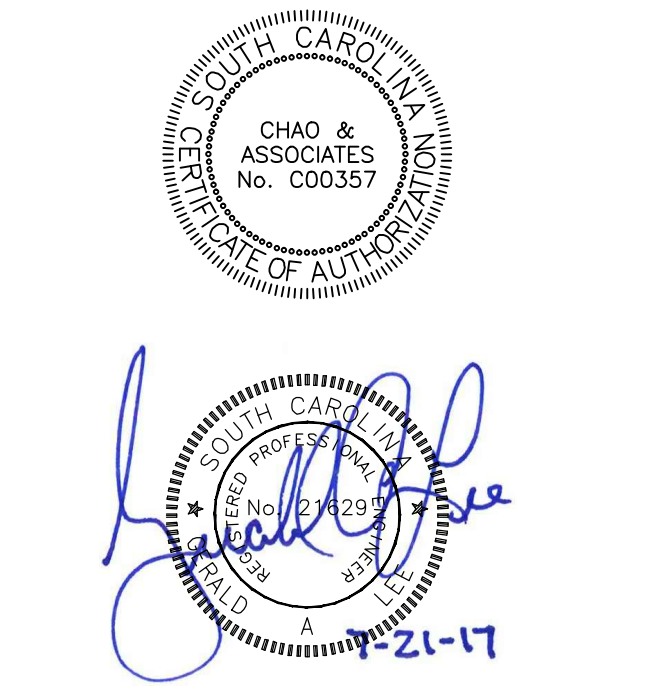

ISSUE DATE: AUGUST 30, 2017
 PHASE: CONSTRUCTION DOCUMENTS

#	DATE	REVISION

Chao & Associates, Inc.
 Civil - Structural - Survey
 7 Clusters Court
 Columbia, SC 29210
 Voice: (803) 772-8420
 Fax: (803) 772-9120
 Email: consult@chaoinc.com